

INSTRUCTION MANUAL - GUIDE D'INSTALLATION

R010

With vertical column / Avec montant vertical

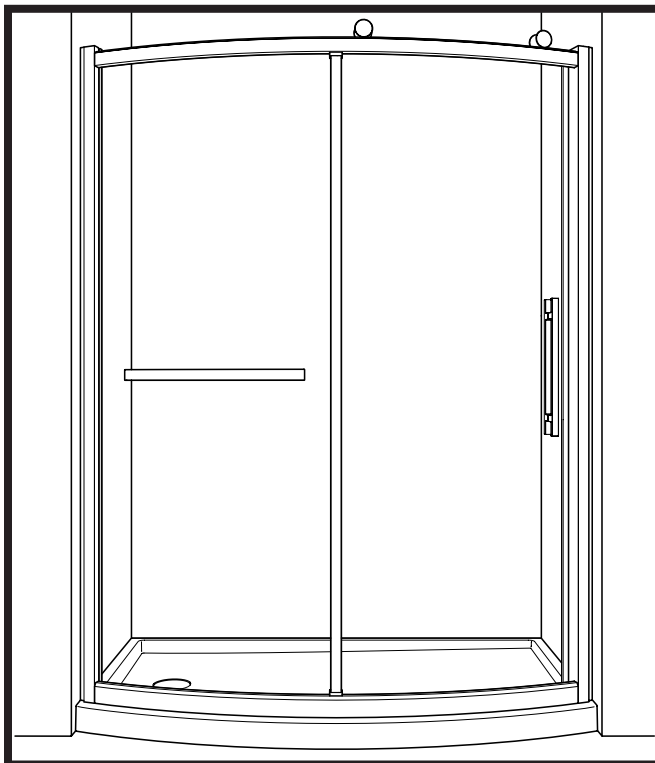

Without vertical column / Sans montant vertical

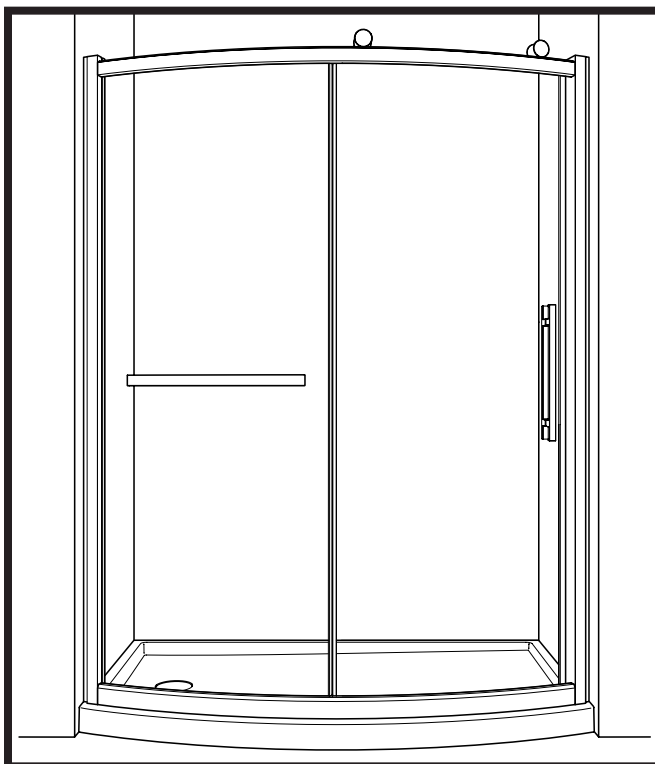

**Please keep this manual and product code number for future reference
and for ordering replacement parts if necessary.**

***Veillez conserver ce manuel et le code de produit pour des références futures,
et au besoin, la commande de pièces de rechange.***

GENERAL INSTRUCTIONS

- Read this manual carefully and completely before proceeding.
- It is recommended that you wear safety glasses at all times during the installation.

En

INSTALLATION OVER CERAMIC TILES

- If your shower door is to be installed over ceramic tiles, the tiles should lay completely under the wall jamb.
- Silicone should be used to seal the gap where the ceramic tiles meet the fixed panel.

NOTICE

- Caulking: no sealant is required inside the shower, unless otherwise stated.
- Some models are equipped with clear sealing gaskets.

CARE FOR YOUR SHOWER DOOR

- Never use scouring powder pads or sharp instruments on metal pieces or glass panels. An occasional wiping down with a mild soap diluted in water is all that is needed to keep the panels and aluminum parts looking new.
- We recommend wiping the glass panels with a squeegee after each use.

INSTRUCTIONS GÉNÉRALES

- Lire attentivement et complètement le manuel d'installation avant de procéder.
- Il est recommandé de porter des lunettes de sécurité en tout temps lors de l'installation.

Fr

INSTALLATION SUR LES TUILES EN CÉRAMIQUE

- Si votre porte de douche doit être installée sur une bordure en céramique, le jambage doit reposer complètement sur cette dernière.
- Le calfeutrage doit être appliqué sur le côté extérieur de la douche où le panneau fixe rencontre la bordure en céramique.

NOTE

- Calfeutrage: aucun scellant n'est nécessaire à l'intérieur de la douche.
- Certains modèles sont dotés de joints d'étanchéité clairs.

L'ENTRETIEN DE VOTRE DOUCHE

- Ne jamais utiliser de poudre ou de tampon à recurer, ni d'instrument tranchant sur les parties en métal ou en verre. De temps à autre, il suffit de nettoyer la porte avec une solution d'eau et un détergent doux pour conserver l'aspect neuf des panneaux de verre et du cadre en aluminium.
- Nous recommandons de passer une raclette de douche sur les panneaux de verre après chaque utilisation.

POSSIBLE CONFIGURATIONS / CONFIGURATIONS POSSIBLES

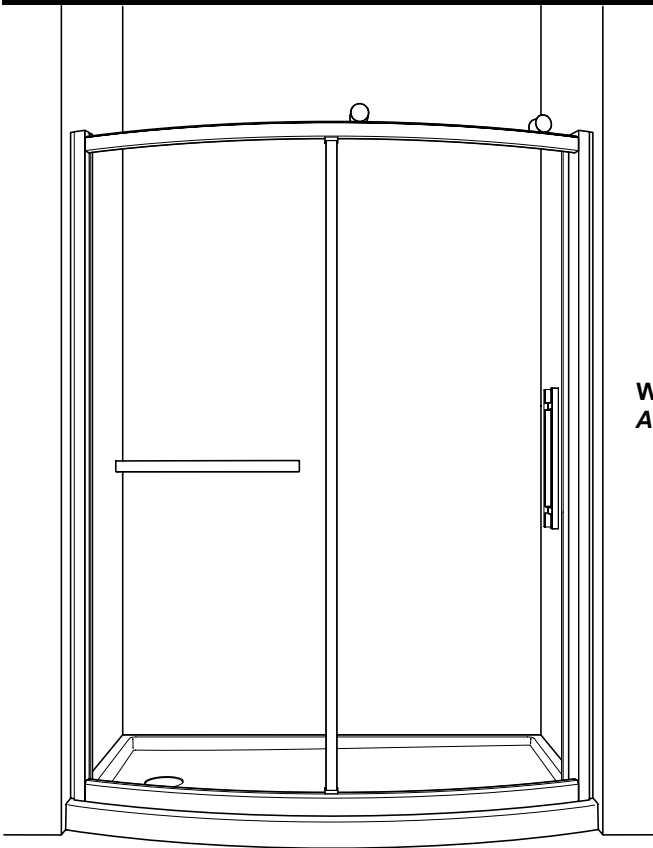

**With vertical column /
Avec montant vertical**

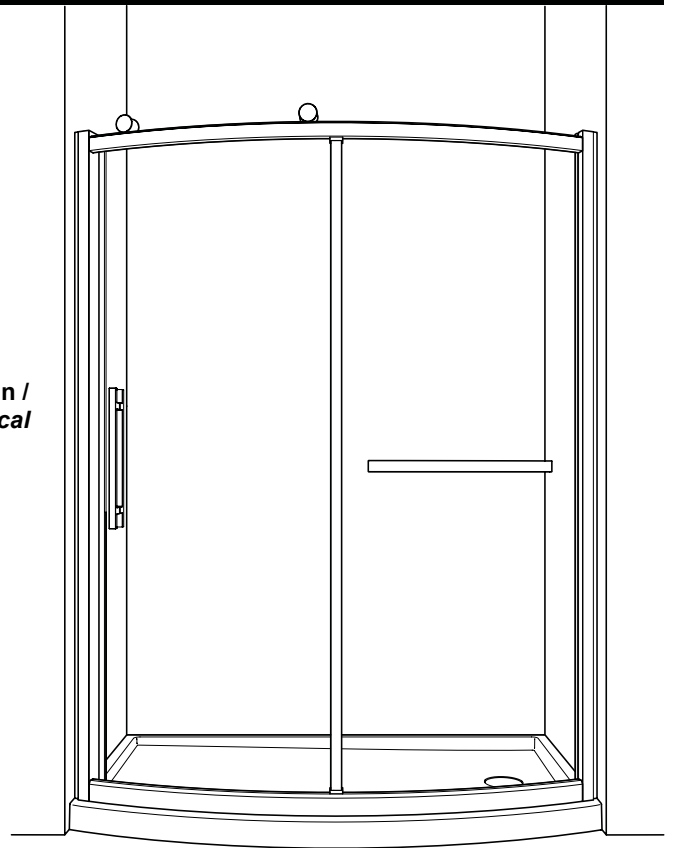

These configurations are shown in the installation.

Ces configurations sont illustrées dans l'installation.

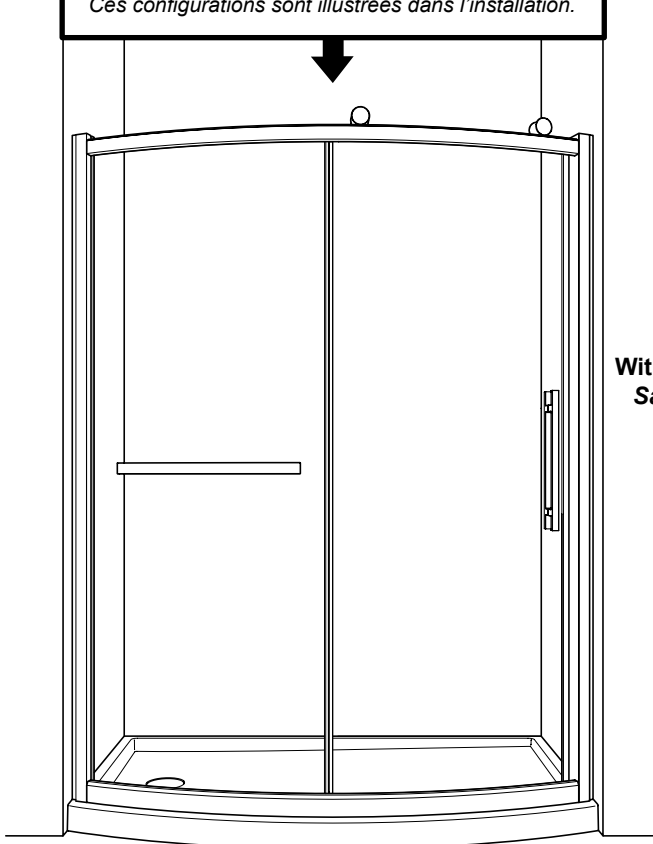

**Without vertical column /
Sans montant vertical**

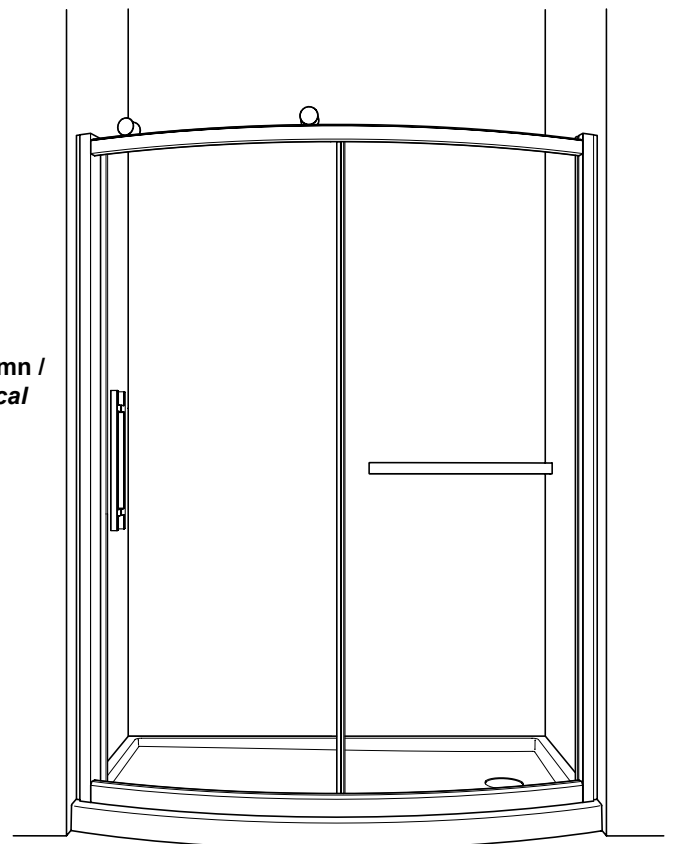

TOOLS AND MATERIAL REQUIRED / OUTILS ET MATÉRIAUX REQUIS

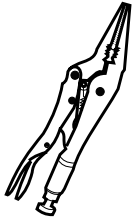

LONG NOSE LOCKING PLIERS (X2)
PINCE SERRE ÉTAU (X2)



SCREWDRIVER
TOURNEVIS



SCREWDRIVER
TOURNEVIS

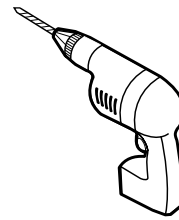

DRILL
PERCEUSE

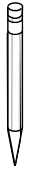

PENCIL
CRAYON

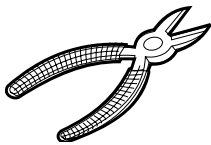

CUTTING PLIERS
PINCE COUPANTE

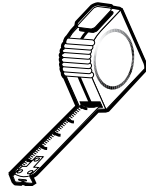

TAPE MEASURE
RUBAN À MESURER

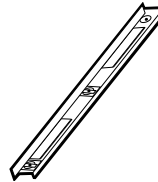

LEVEL
NIVEAU

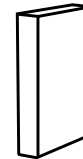

BLOCK
BLOC

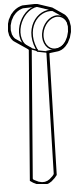

MALLET
MAILLET

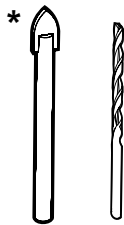

1/4" & 1/8" DRILL BITS
MÈCHE 1/4" & 1/8"

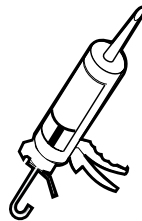

SILICONE
SCELLANT



5/16" HEX NUT DRIVER
TOURNE-ÉCROU 5/16"

*** Use a 1/4" drill bit when drilling into ceramic tiles**

** Utiliser une mèche de 1/4" pour percer des tuiles en céramique.*

HARDWARE / QUINCAILLERIE

**With vertical column /
Avec montant vertical**

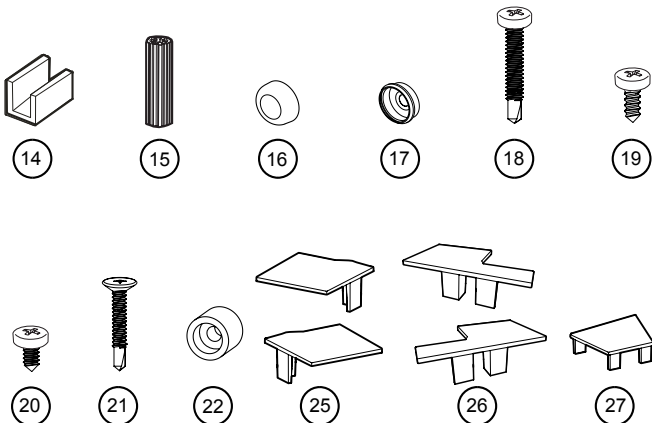

**Without vertical column /
Sans montant vertical**

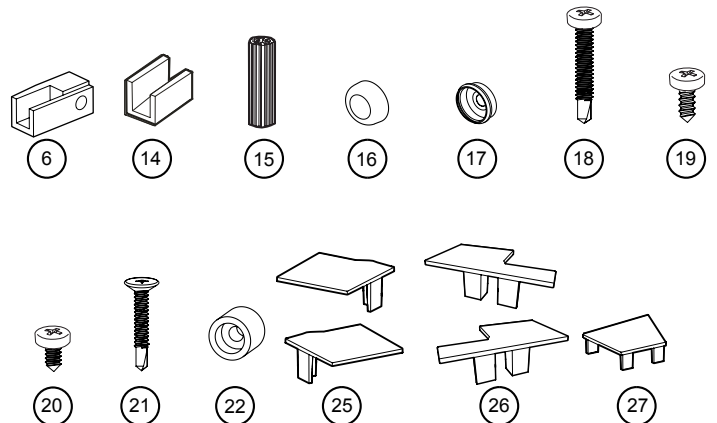

PARTS LISTING (with vertical column) / LISTE DES PIÈCES (avec montant vertical)

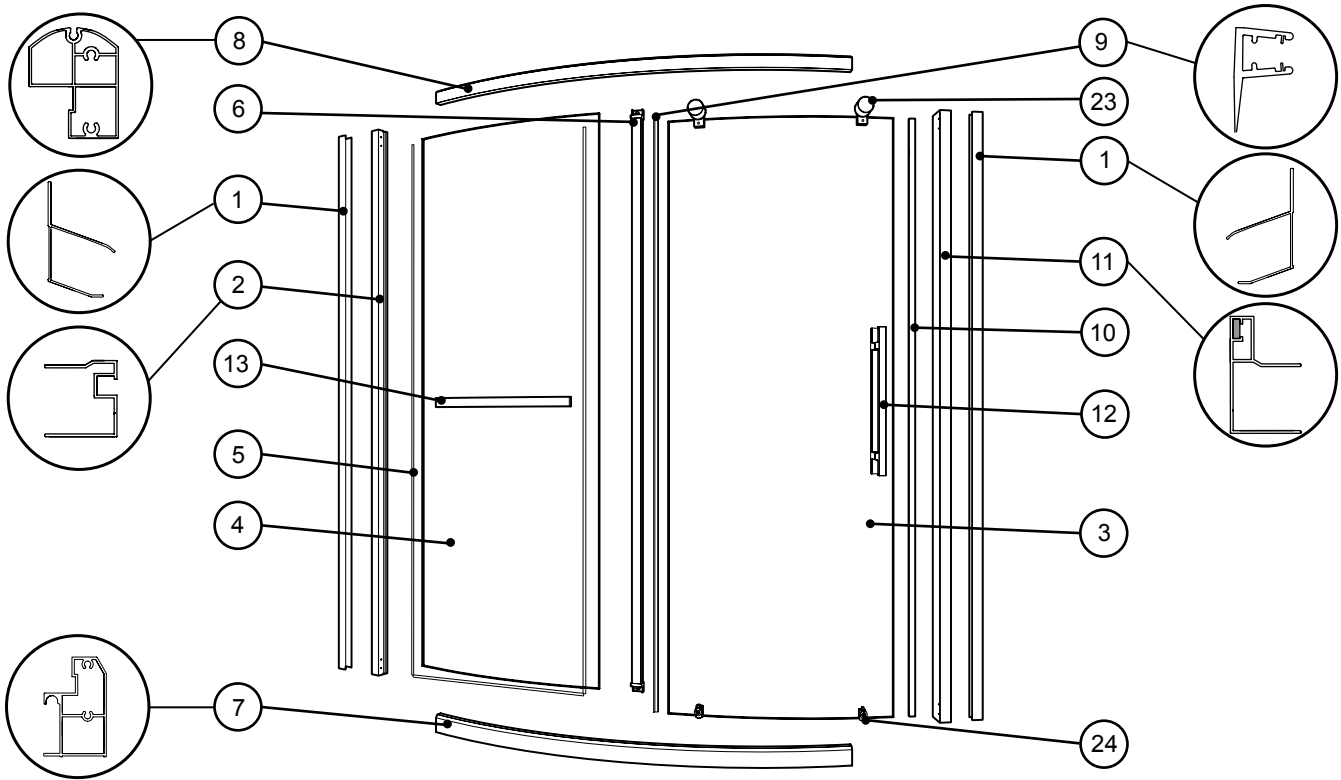

ITEM	PARTS - PIÈCES	QTY
1	WALL JAMB / JAMBAGE	2
2	EXPANDER / EXTENSEUR	1
3	DOOR PANEL / PANNEAU DE PORTE	1
4	FIXED PANEL / PANNEAU FIXE	1
5	VERTICAL GASKET / JOINT VÉRTICAL	2
6	VERTICAL COLUMN / MONTANT VÉRTICAL	1
7	BOTTOM TRACK / RAIL INFÉRIEUR	1
8	TOP TRACK / RAIL SUPÉRIEUR	1
9	SIDE GASKET / JOINT LATÉRAL	1
10	MAGNETIC DOOR GASKET / JOINT MAGNÉTIQUE	1
11	MAGNETIC EXPANDER / EXTENSEUR MAGNÉTIQUE	1
12	HANDLE / POIGNÉE	1
13	TOWEL BAR / BARRE À SERVIETTE	1
14	GLASS SUPPORT / SUPPORT DE VERRE	4
15	WALL PLUG / CHEVILLE	8
16	SCREW CAP / CAPUCHON COUVRE-VIS	8
17	BACK SCREW CAP / L'ARRIÈRE DU CAPUCHON COUVRE-VIS	8
18	PAN SELF DRILLING SCREW #M4-35 / VIS PAN AUTO-PERÇANTE #M4-35	16
19	PAN HEAD SCREW #M4-12 / VIS PAN #M4-12	1
20	PAN SCREW #M4-10 / VIS PAN #M4-10	6
21	FLAT HEAD SCREW #M4-20 / VIS À TÊTE PLATE #M4-20	2
22	STOPPER / BUTOIR	1
23	TOP WHEEL / ROULETTE SUPÉRIEUR	2
24	BOTTOM WHEEL / ROULETTE INFÉRIEUR	2
25	COVER FOR THE EXPANDER / CAPUCHON POUR L'EXTENSEUR	1
26	COVER FOR THE MAGNETIC EXPANDER / CAPUCHON POUR L'EXTENSEUR MAGNÉTIQUE	1
27	COVER FOR THE WALL JAMB / CAPUCHON POUR LE JAMBAGE	2

PARTS LISTING (without vertical column) / LISTE DES PIÈCES (sans montant vertical)

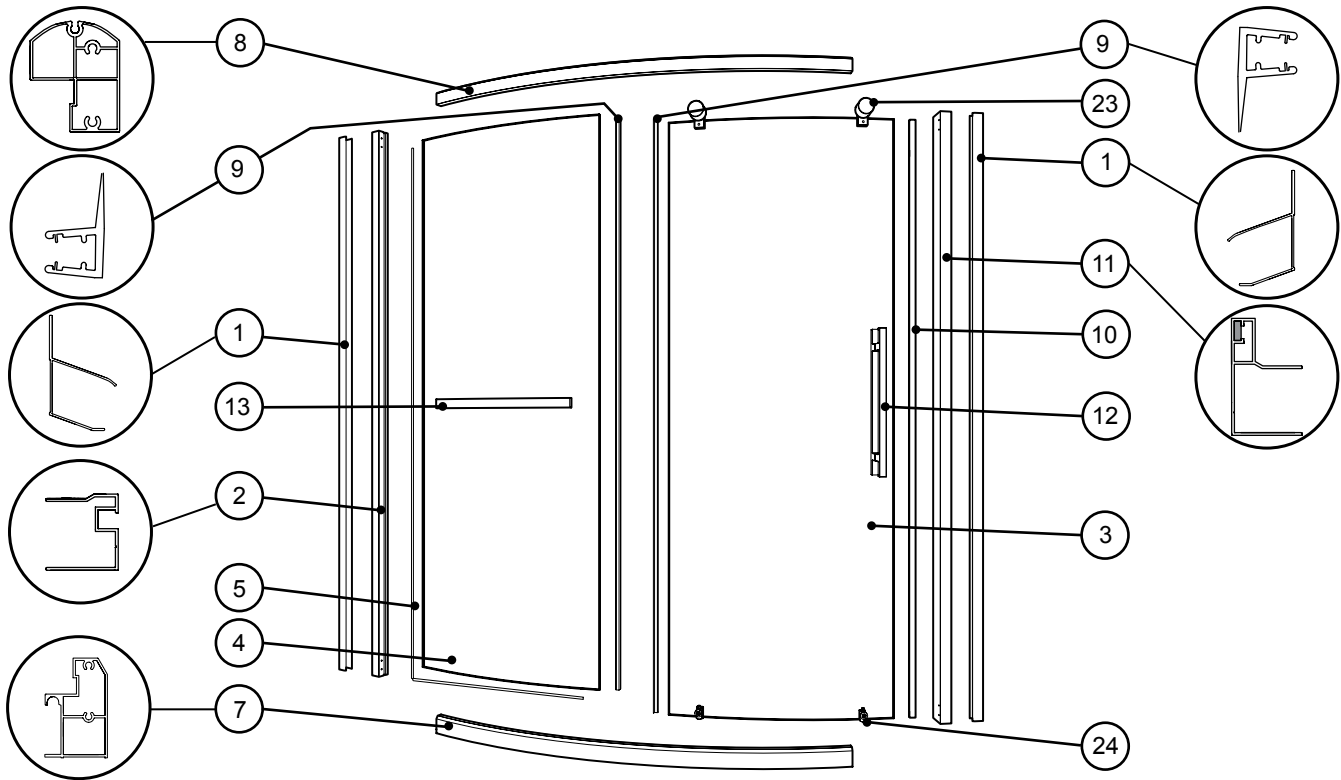

ITEM	PARTS - PIÈCES	QTY
1	WALL JAMB / JAMBAGE	2
2	EXPANDER / EXTENSEUR	1
3	DOOR PANEL / PANNEAU DE PORTE	1
4	FIXED PANEL / PANNEAU FIXE	1
5	VERTICAL GASKET / JOINT VÉRTICAL	2
6	GLASS FASTENER / FIXATION DE VERRE	2
7	BOTTOM TRACK / RAIL INFÉRIEUR	1
8	TOP TRACK / RAIL SUPÉRIEUR	1
9	SIDE GASKET / JOINT LATÉRAL	2
10	MAGNETIC DOOR GASKET / JOINT MAGNÉTIQUE	1
11	MAGNETIC EXPANDER / EXTENSEUR MAGNÉTIQUE	1
12	HANDLE / POIGNÉE	1
13	TOWEL BAR / BARRE À SERVIETTE	1
14	GLASS SUPPORT / SUPPORT DE VERRE	4
15	WALL PLUG / CHEVILLE	8
16	SCREW CAP / CAPUCHON COUVRE-VIS	8
17	BACK SCREW CAP / L'ARRIÈRE DU CAPUCHON COUVRE-VIS	8
18	PAN SELF DRILLING SCREW #M4-35 / VIS PAN AUTO-PERÇANTE #M4-35	16
19	PAN HEAD SCREW #M4-12 / VIS PAN #M4-12	1
20	PAN SCREW #M4-10 / VIS PAN #M4-10	6
21	FLAT HEAD SCREW #M4-20 / VIS À TÊTE PLATE #M4-20	2
22	STOPPER / BUTOIR	1
23	TOP WHEEL / ROULETTE SUPÉRIEUR	2
24	BOTTOM WHEEL / ROULETTE INFÉRIEUR	2
25	COVER FOR THE EXPANDER / CAPUCHON POUR L'EXTENSEUR	1
26	COVER FOR THE MAGNETIC EXPANDER / CAPUCHON POUR L'EXTENSEUR MAGNÉTIQUE	1
27	COVER FOR THE WALL JAMB / CAPUCHON POUR LE JAMBAGE	2

1

MARK THE CENTER LINE / MARQUER LA LIGNE DU CENTRE

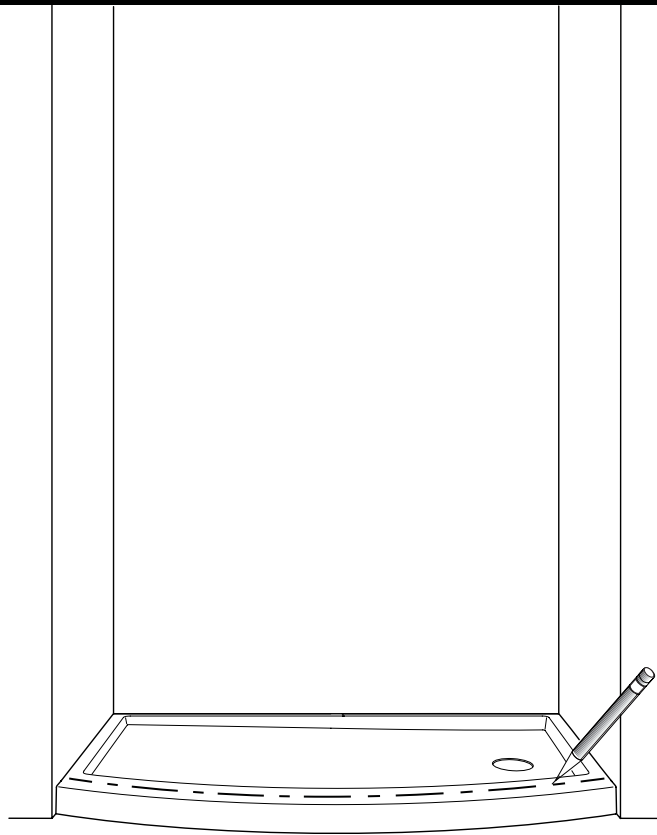

THE INSTALLATION SHOWN IS BASED ON PLUMB FINISHED WALLS AND A LEVELLED BASE. IF THESE CONDITIONS ARE NOT MET, PLEASE ADJUST ACCORDINGLY.

L'INSTALLATION ILLUSTRÉE EST BASÉE SUR DES MURS FINIS D'APLOMB ET UNE BASE DE DOUCHE NIVELÉE. SI CES CONDITIONS NE SONT PAS PRÉSENTÉES, VEUILLEZ AJUSTER EN CONSÉQUENCE.

2

PLACE THE CENTER OF THE WALL JAMB ON THE CENTER LINE / PLACER LE CENTRE DU JAMBAGE SUR LA LIGNE DU CENTRE

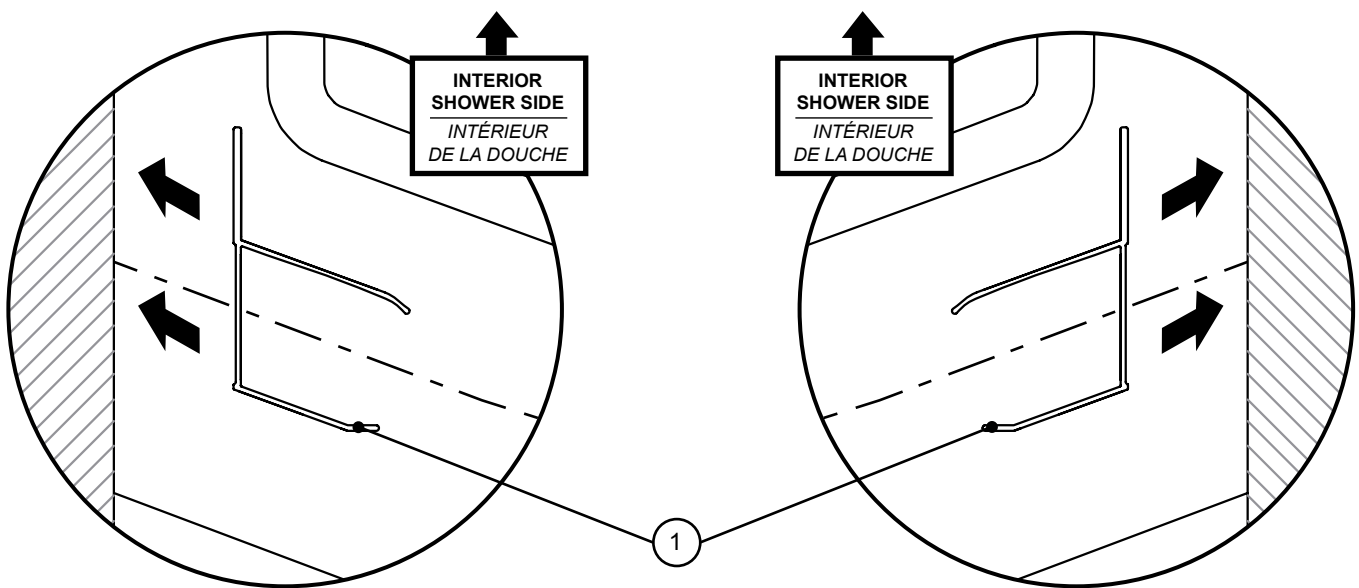

3

MARK THE DRILLING LOCATIONS / MARQUER LES POINTS DE PERÇAGE

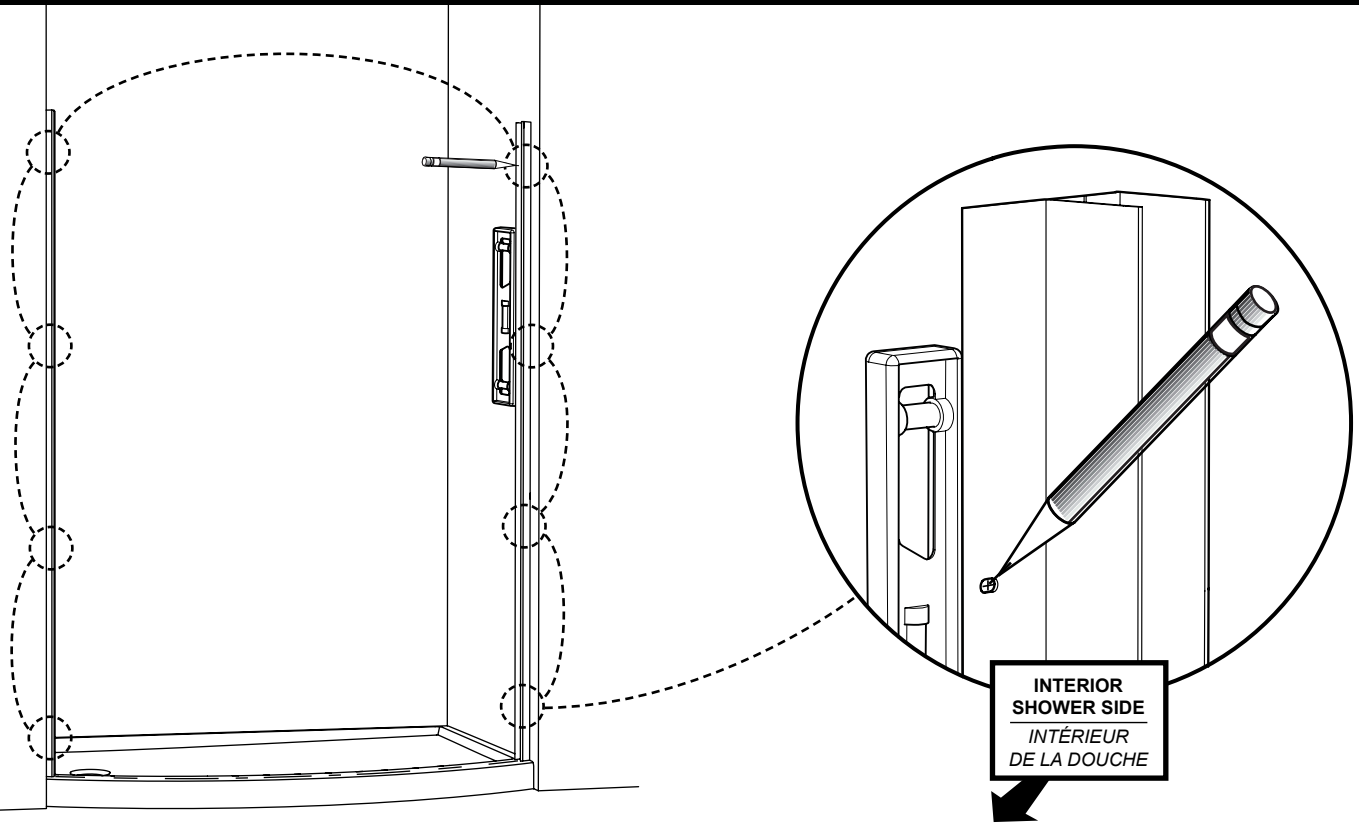

4

DRILL, SILICONE AND INSERT THE WALL PLUGS / PERCER, SILICONE ET INSÉRER LES CHEVILLES

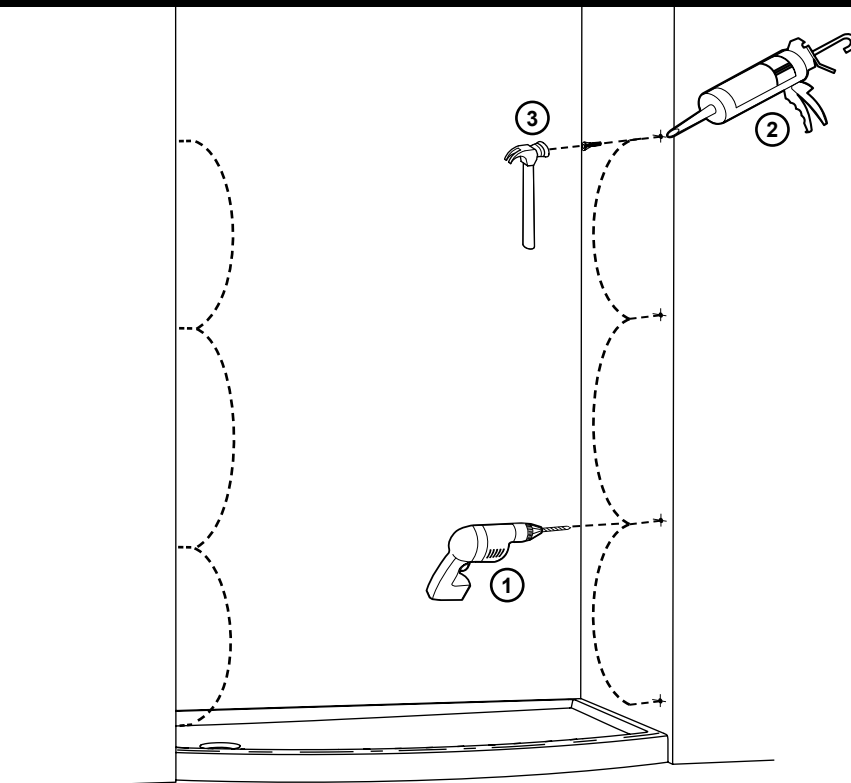

5

SECURE THE WALL JAMB ON THE DOOR SIDE / SÉCURISER LE JAMBAGE SUR LE CÔTÉ DE LA PORTE

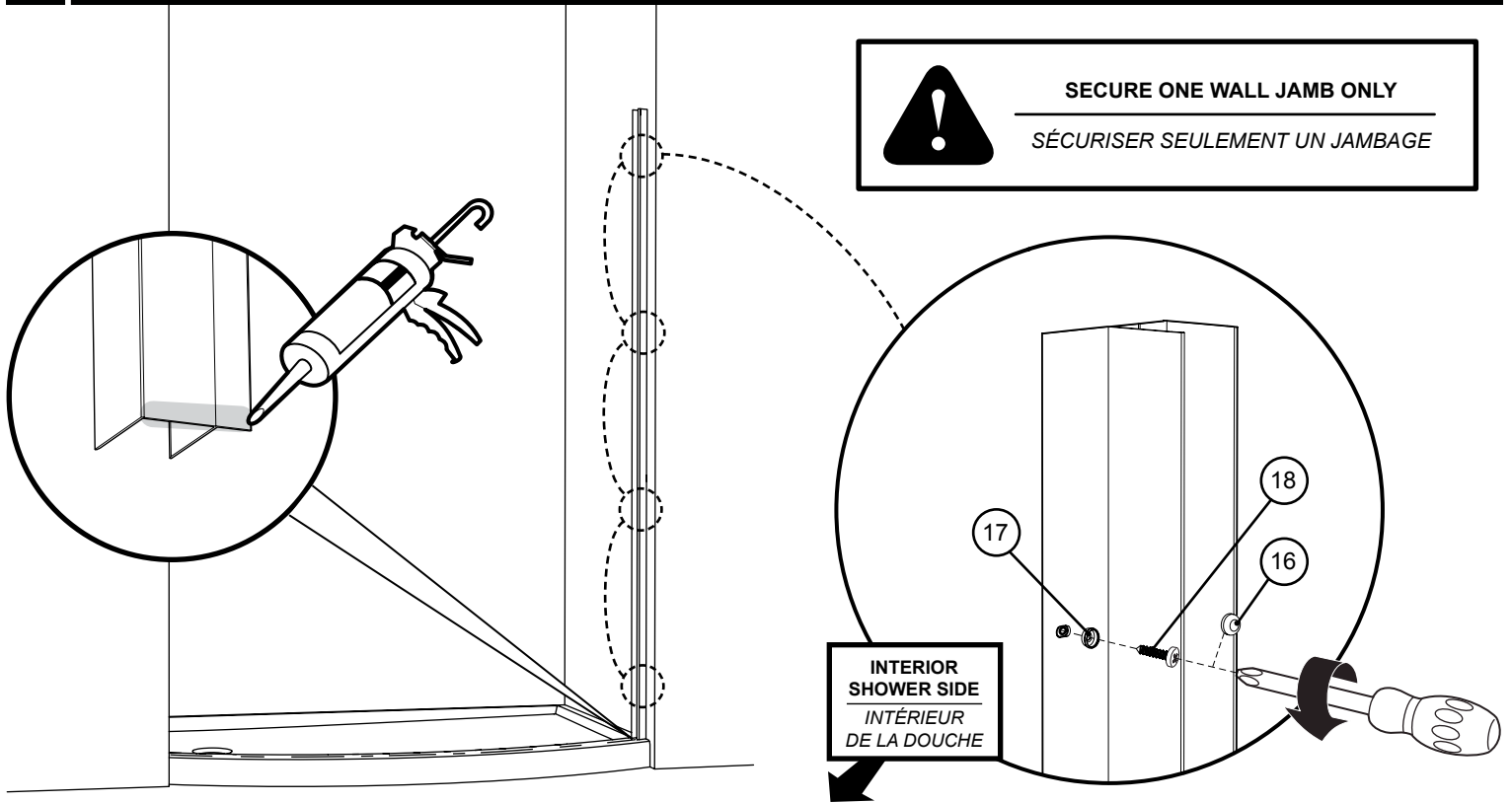

6

ASSEMBLE THE FRAME / ASSEMBLER LE CADRE

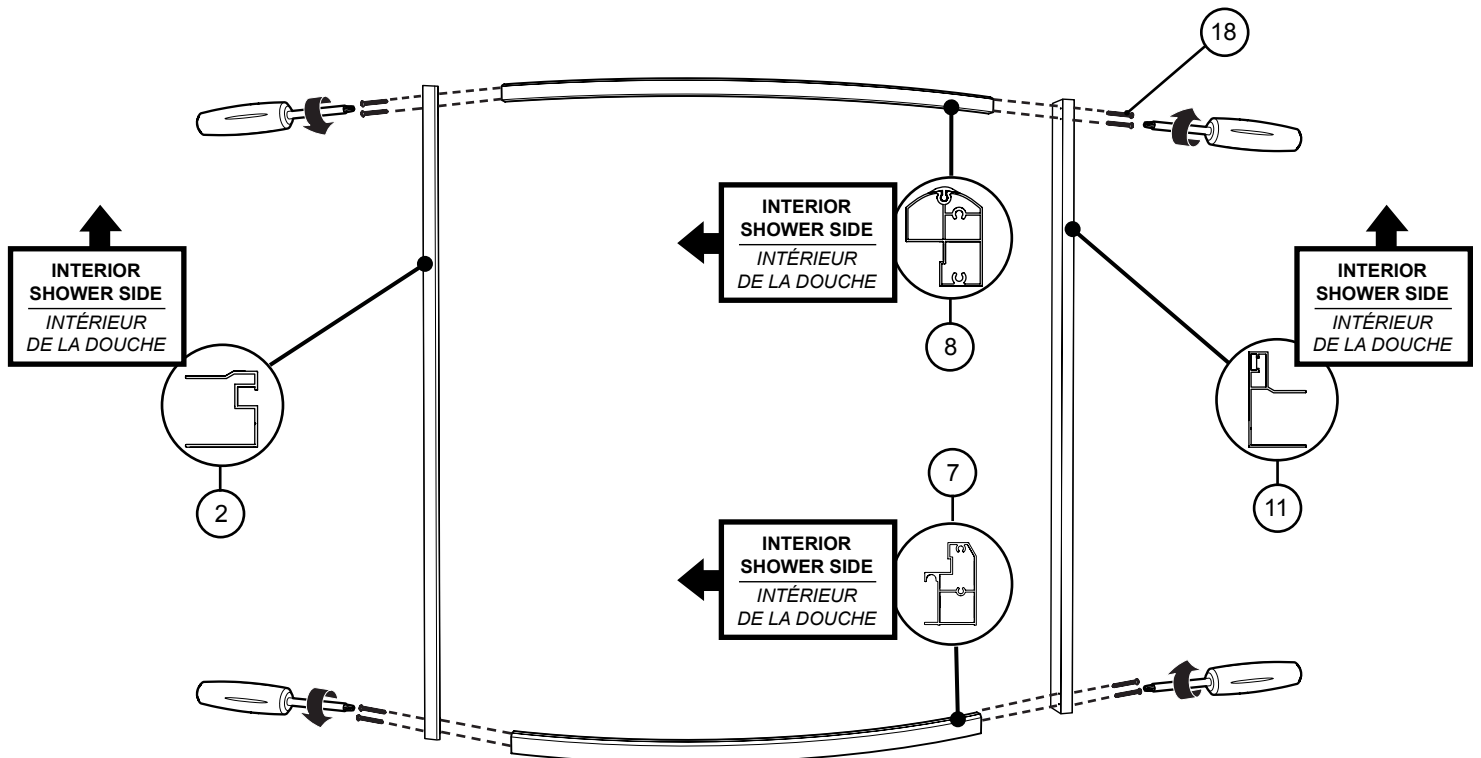

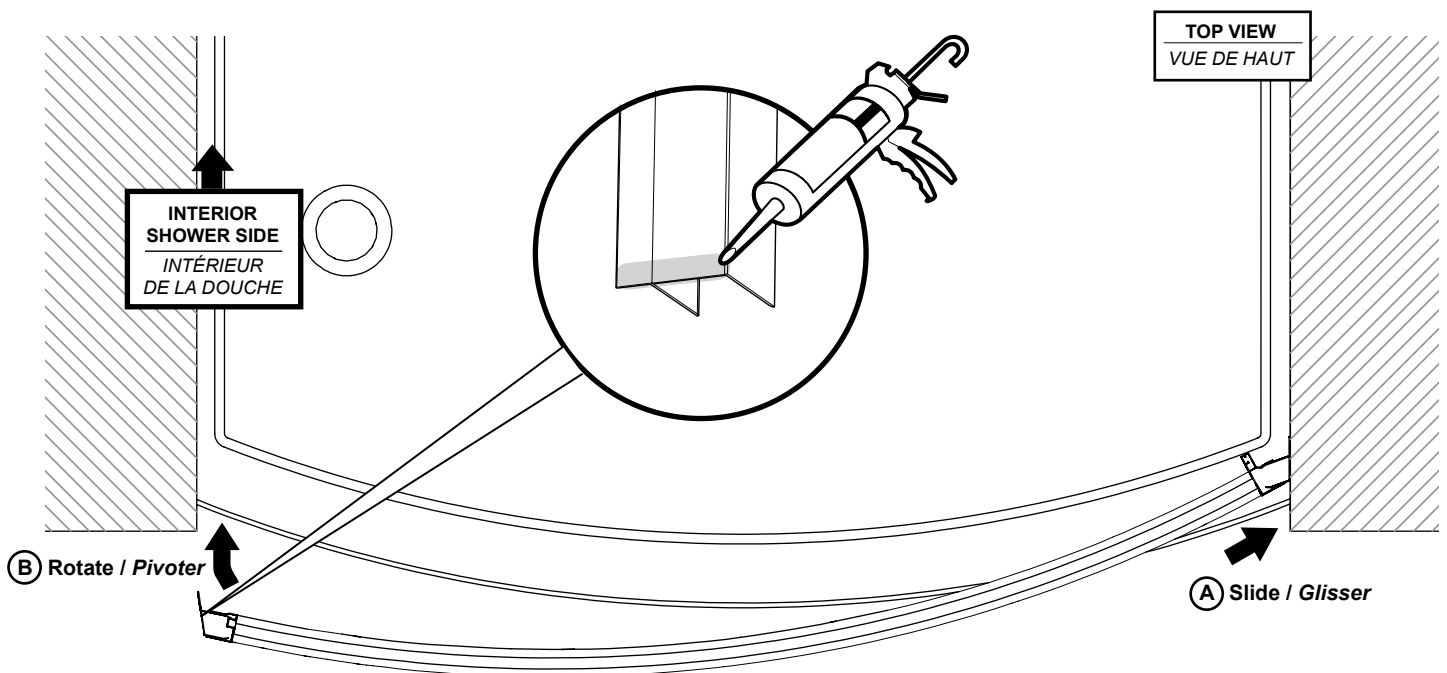
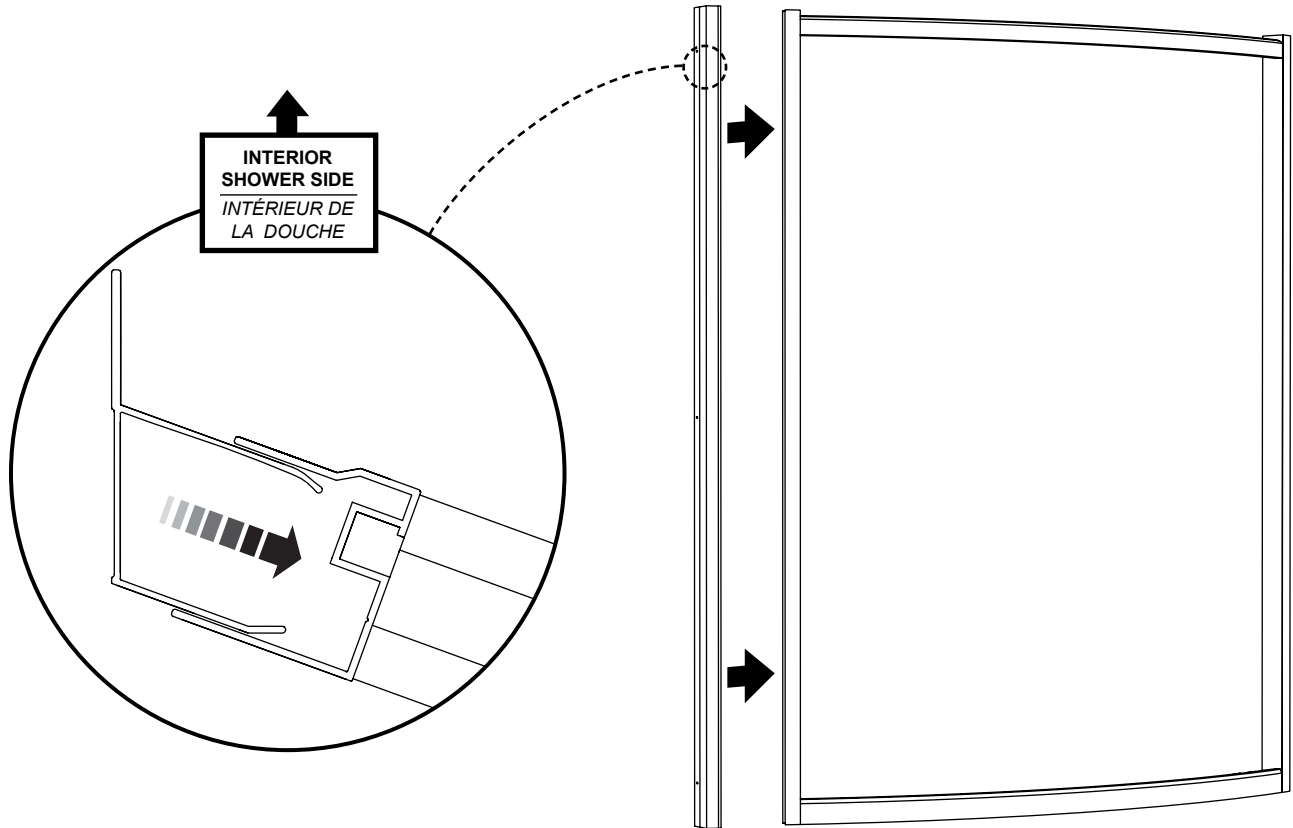

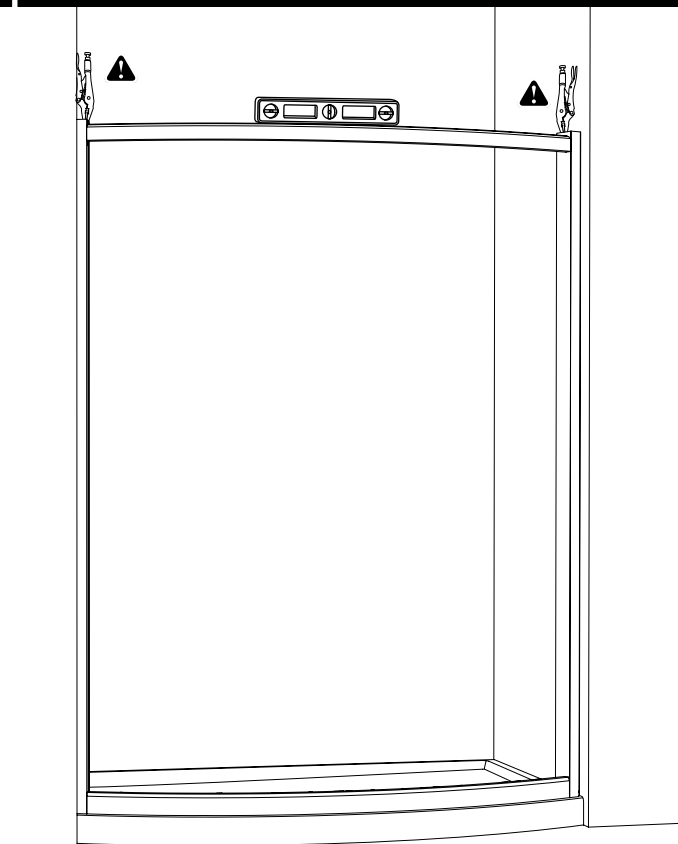
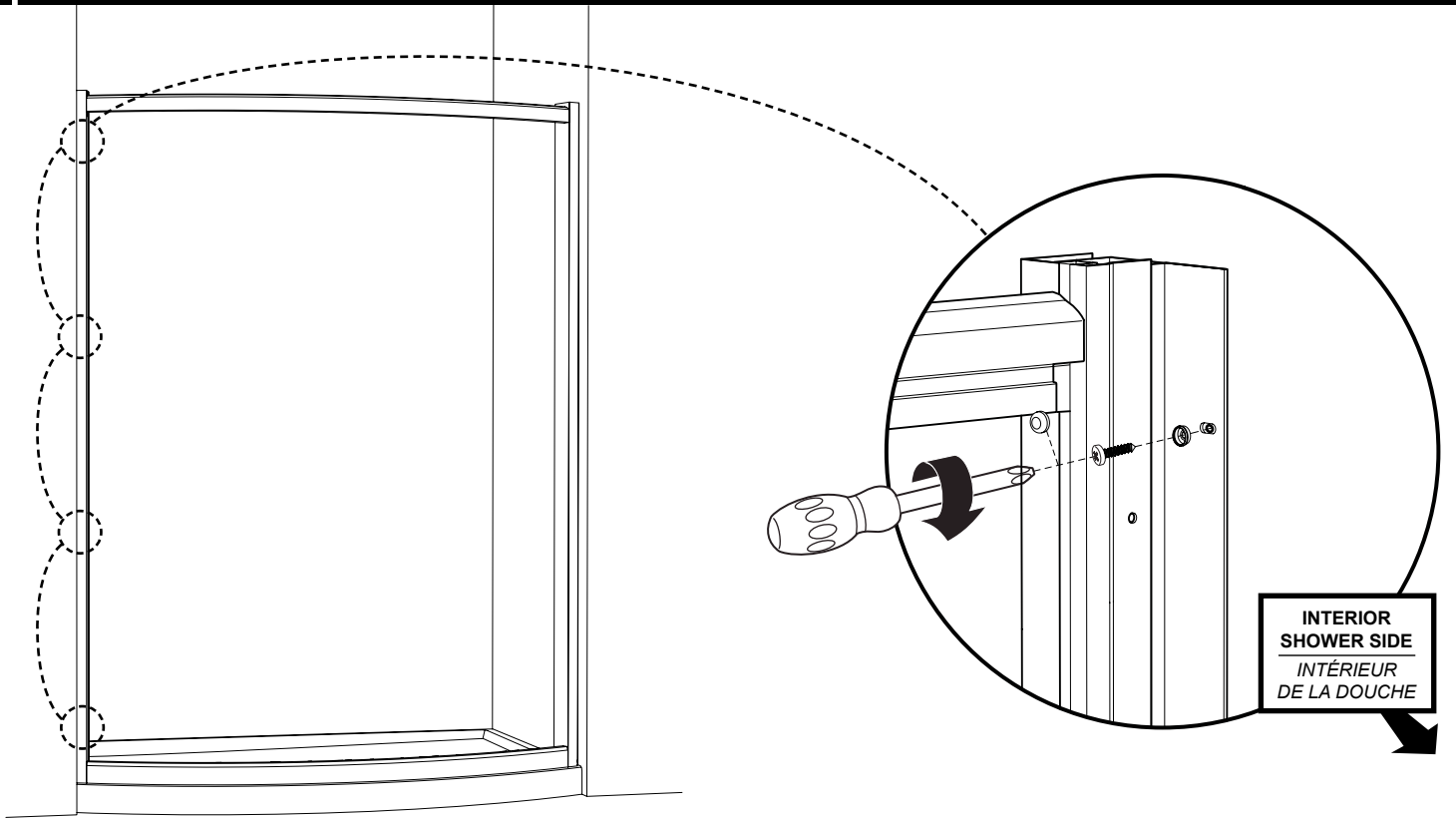

**COVER THE PLIERS' TEETH BEFOREHAND TO
AVOID SCRATCHING THE ALUMINUM PARTS**

**RECOUVRIR LES DENTS DE LA PINCE AFIN DE
NE PAS GRAFIGNER LES PIÈCES EN ALUMINIUM**

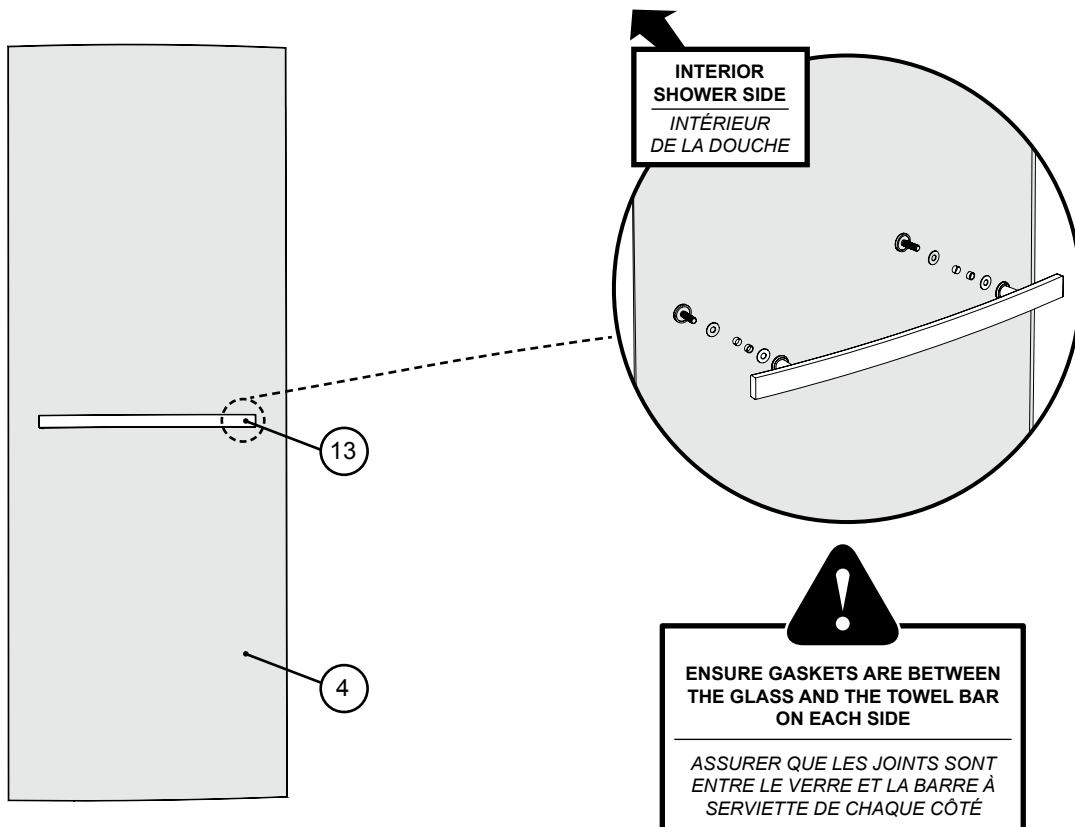
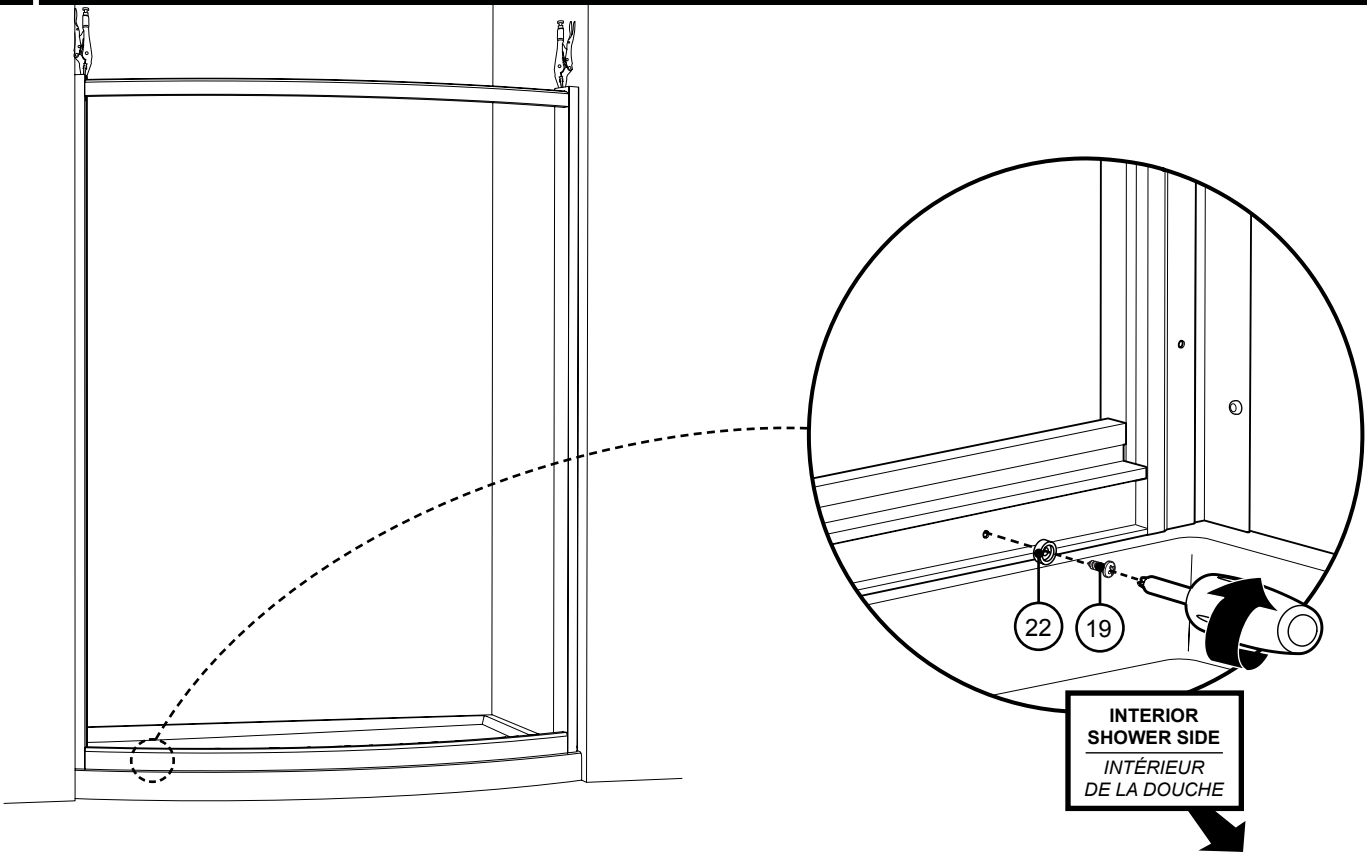

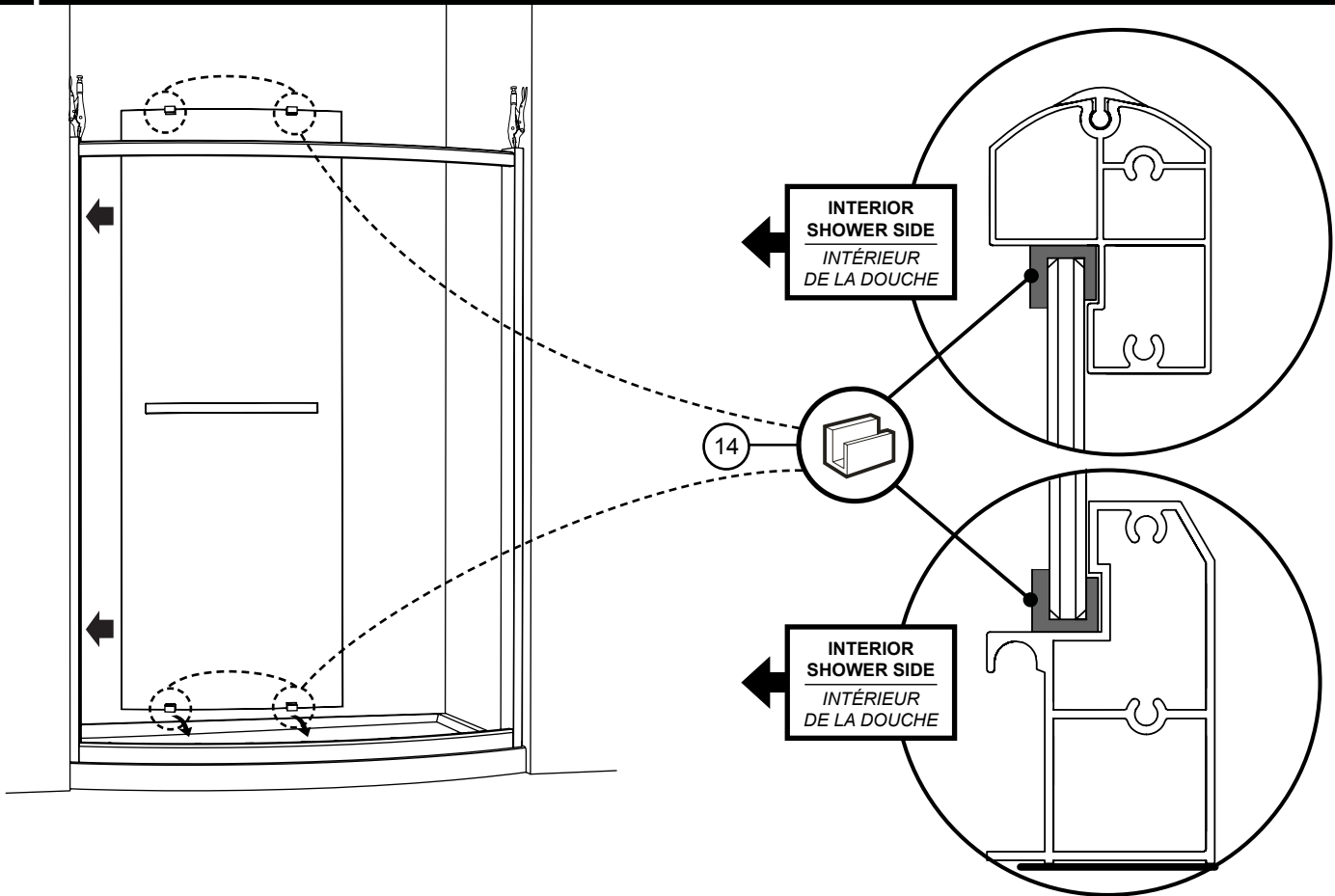
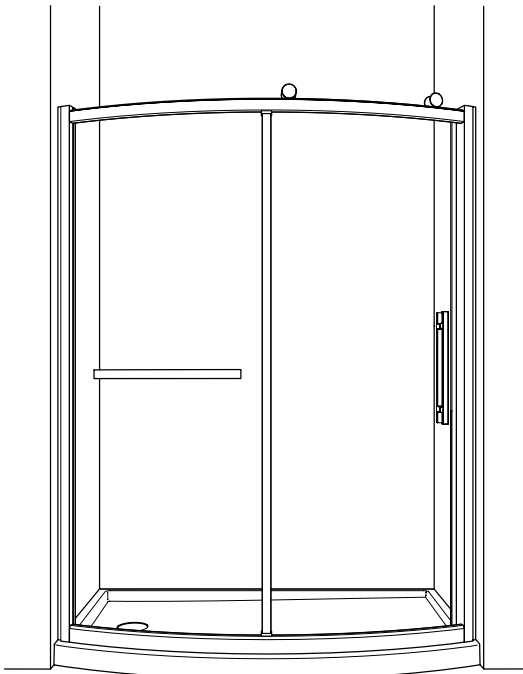
CHOOSE A MIDDLE SUPPORT OPTION / CHOISIR UNE OPTION DE SUPPORT LATÉRAL
A: With vertical column / Avec montant vertical

SEE STEPS 14A TO 15A THEN PROCEED WITH FOLLOWING INSTRUCTIONS
SUIVRE LES ÉTAPES 14A À 15A ET PROCÉDER AVEC LES INSTRUCTIONS

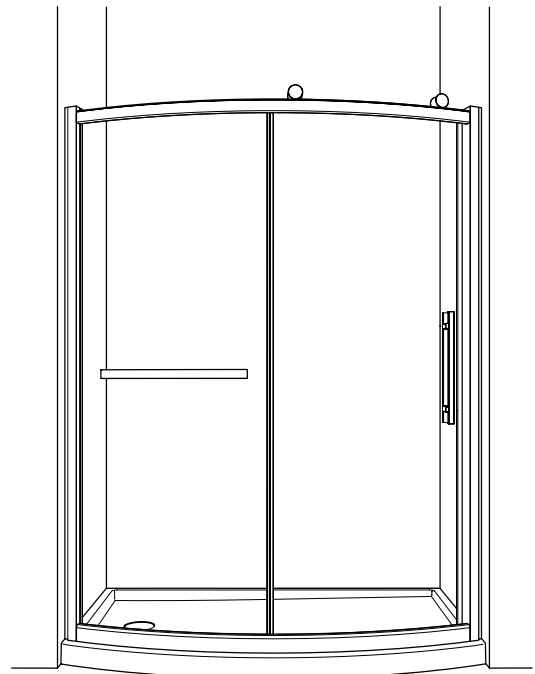
B: Without vertical column / Sans montant vertical

SEE STEPS 14B TO 15B THEN PROCEED WITH FOLLOWING INSTRUCTIONS
SUIVRE LES ÉTAPES 14B À 15B ET PROCÉDER AVEC LES INSTRUCTIONS

14A

SECURE THE VERTICAL COLUMN / SÉCURISER LE MONTANT VERTICAL

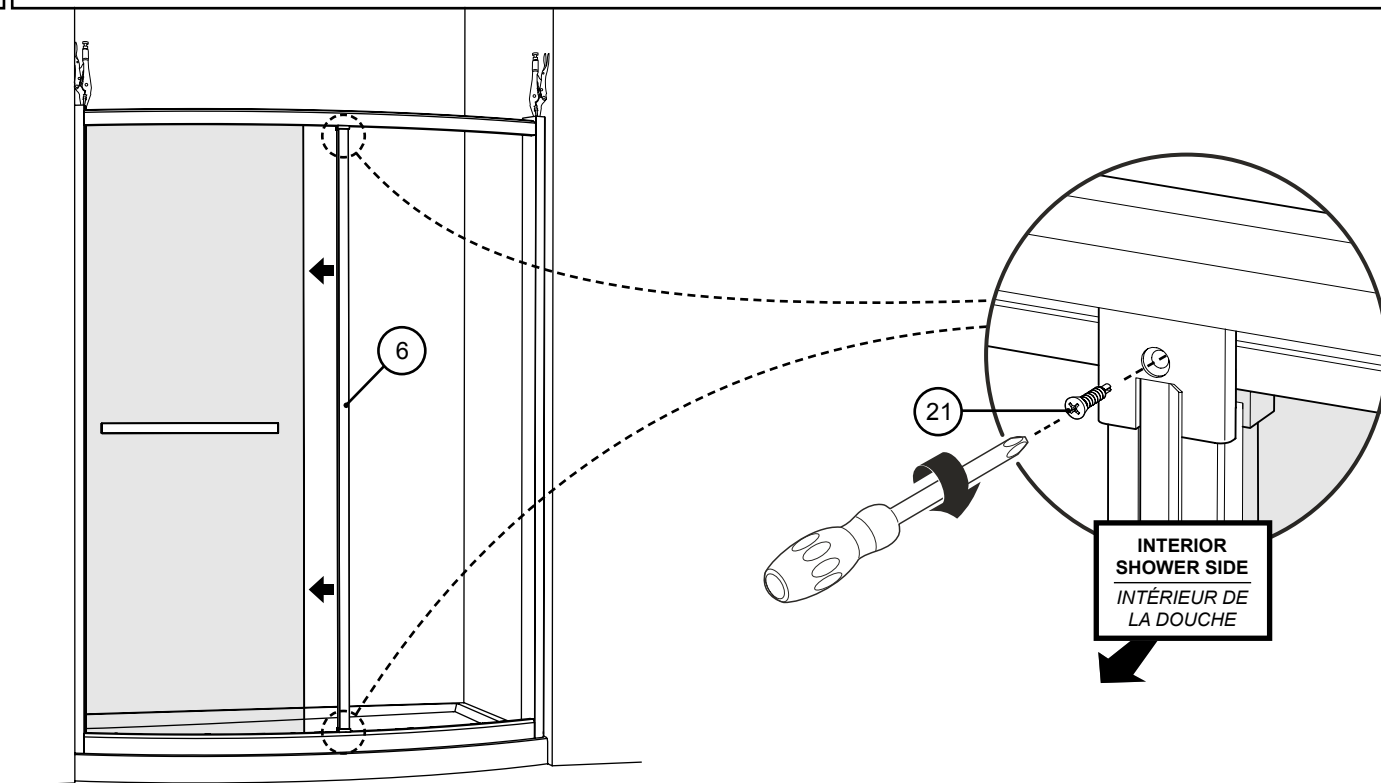

15A

INSTALL THE VERTICAL GASKET / INSTALLER LE JOINT VERTICAL

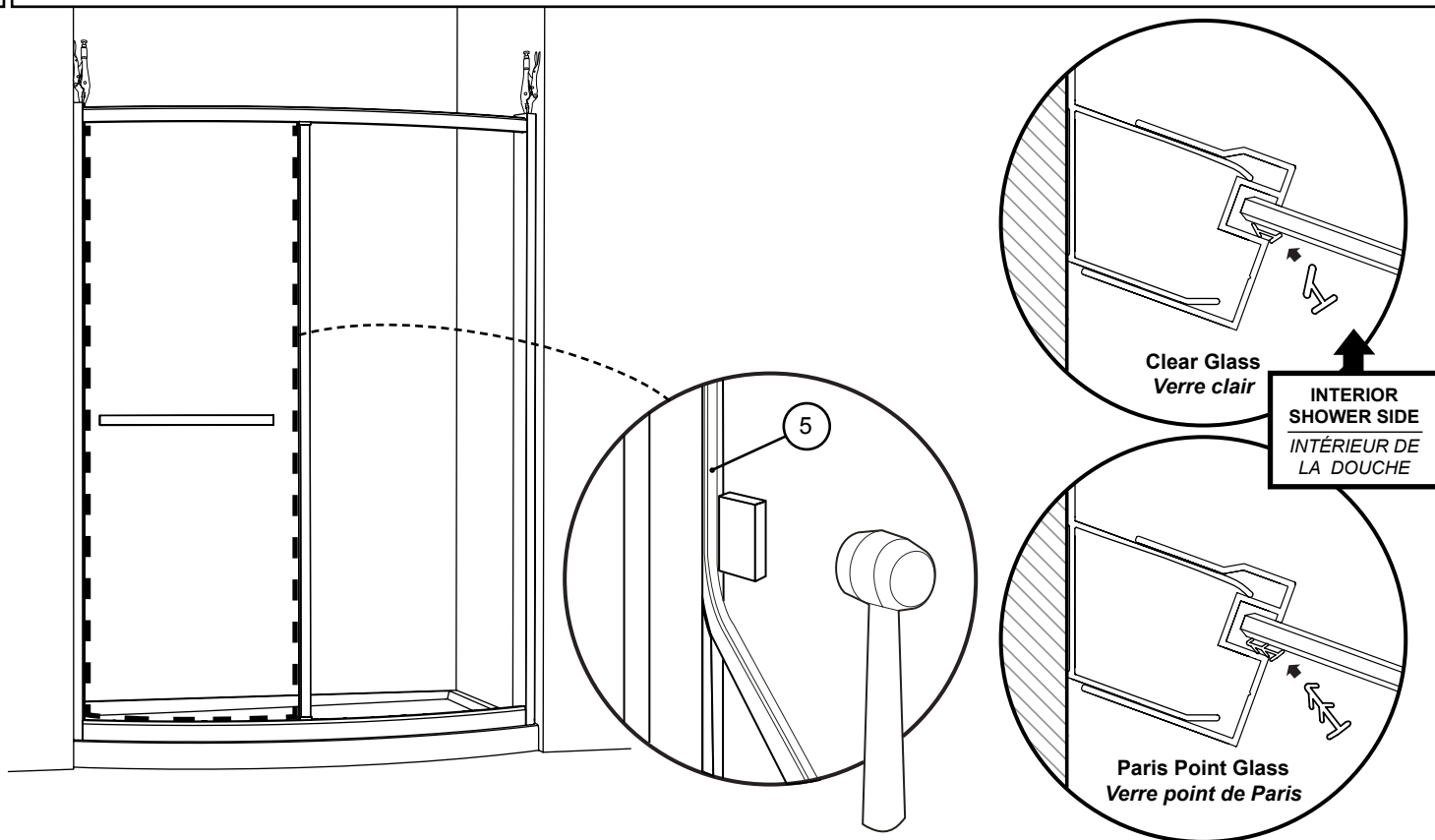

14B

INSTALL THE GLASS FASTENERS / INSTALLER LES FIXATIONS DE VERRE

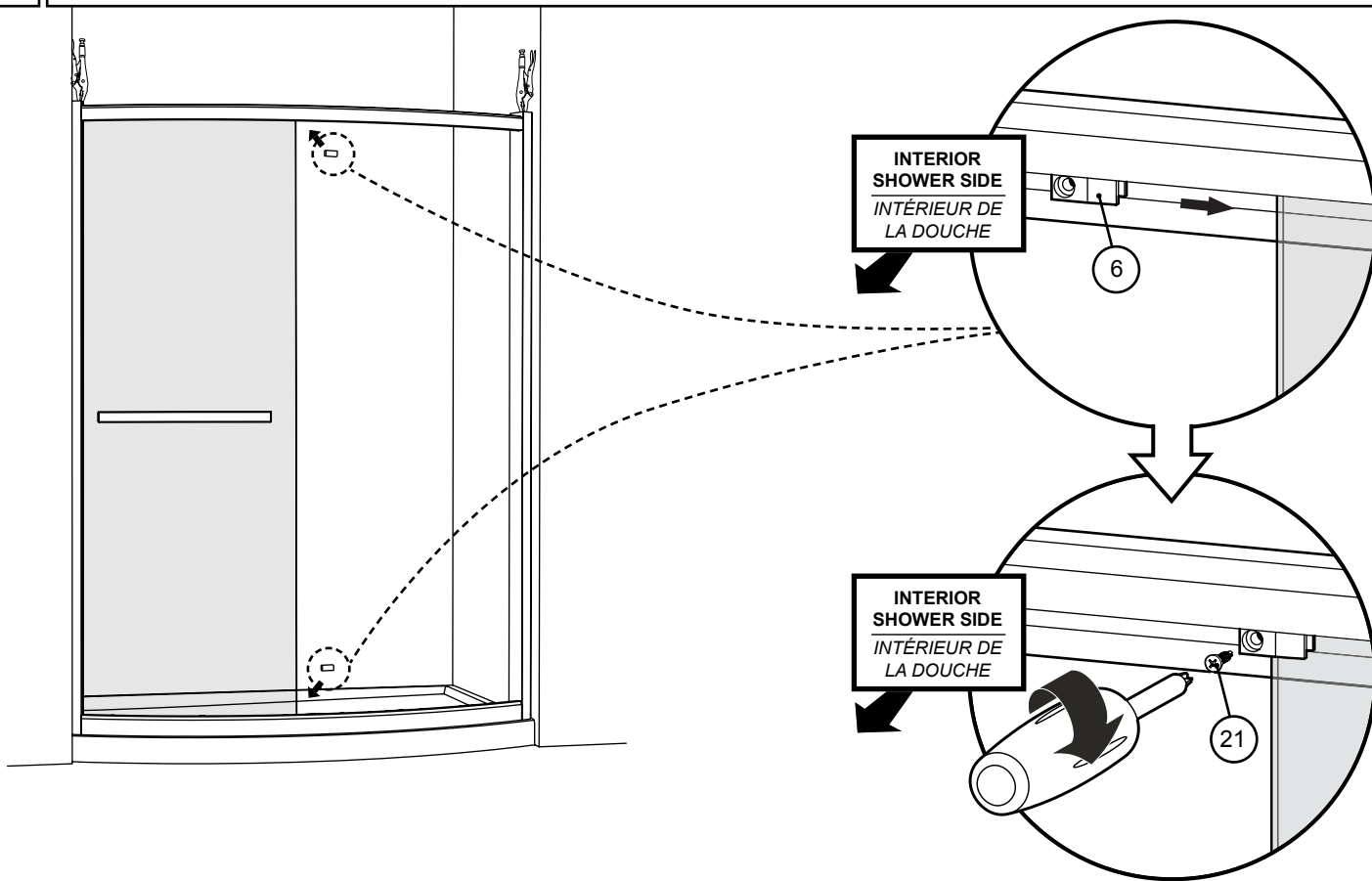

15B

INSTALL THE GASKETS / INSTALLER LES JOINTS

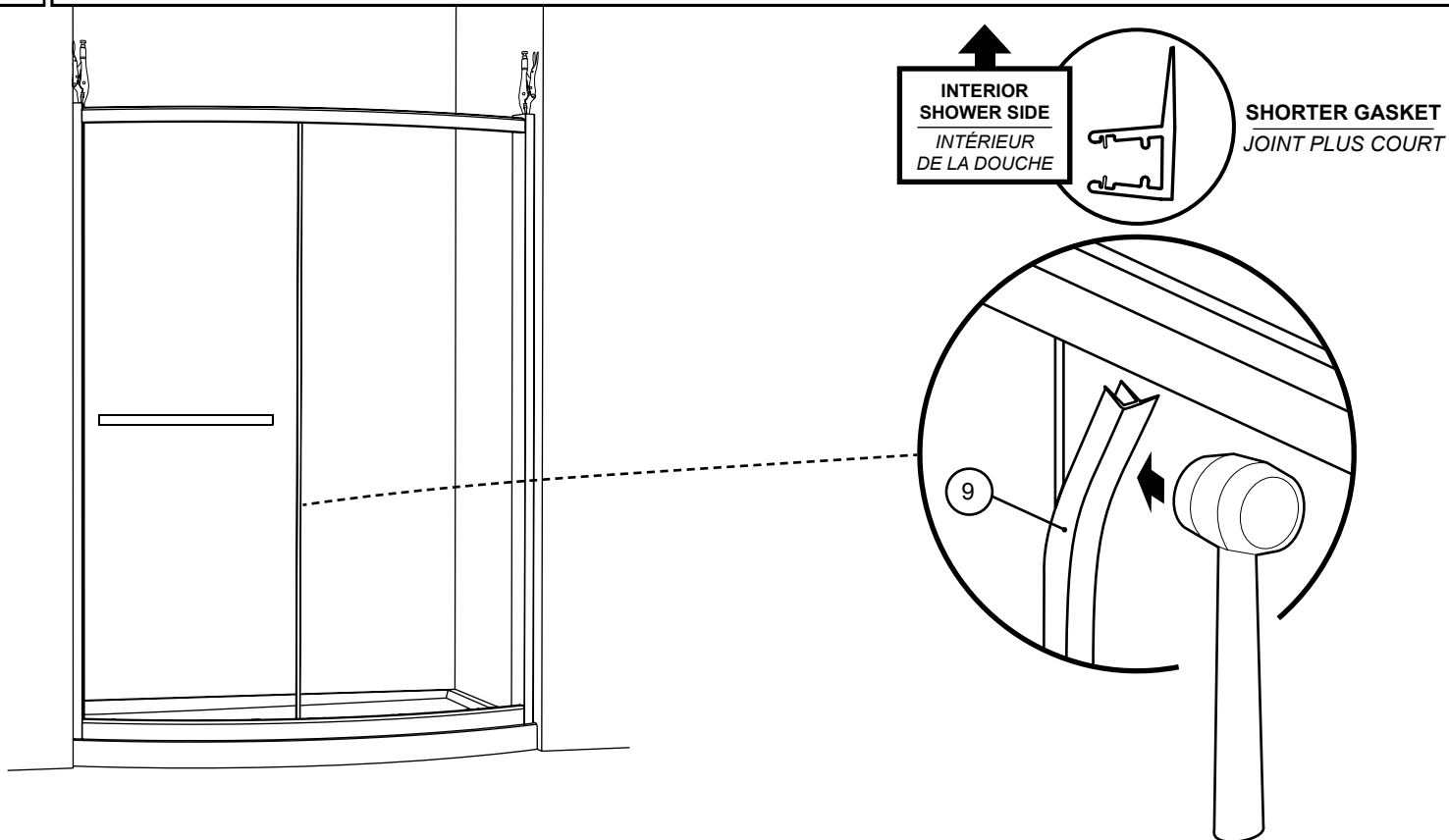

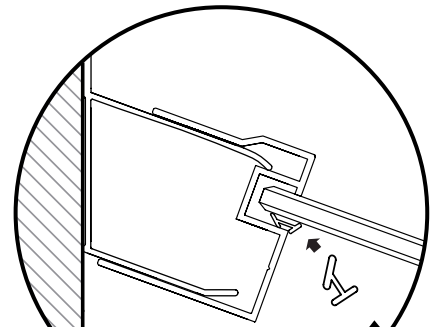
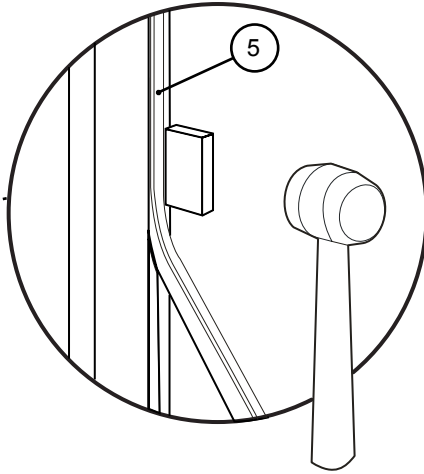
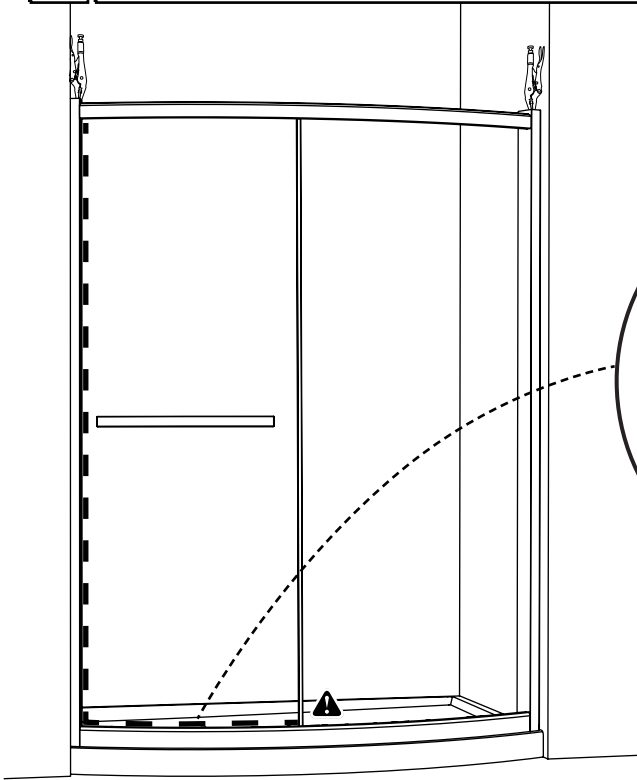

Clear Glass
Verre clair

INTERIOR
SHOWER SIDE
INTÉRIEUR DE
LA DOUCHE

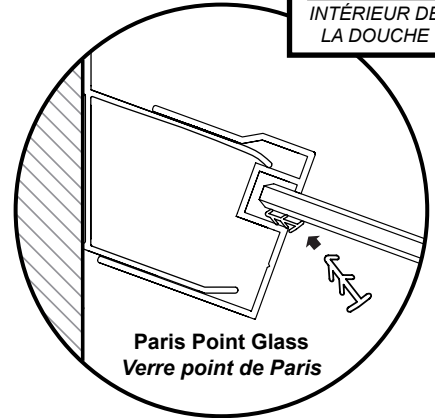

Paris Point Glass
Verre point de Paris



CUT EXCESS GASKET
COUPER L'EXCÉDENT DU JOINT

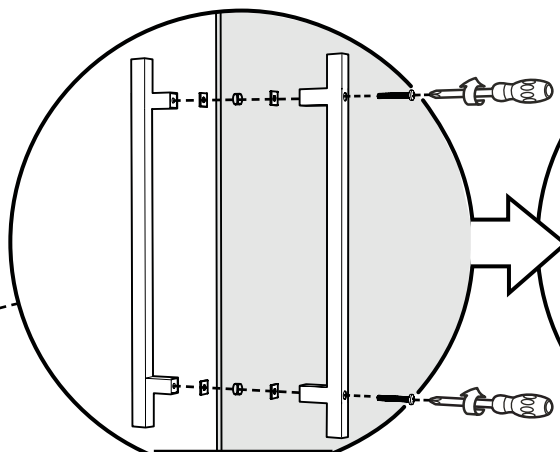
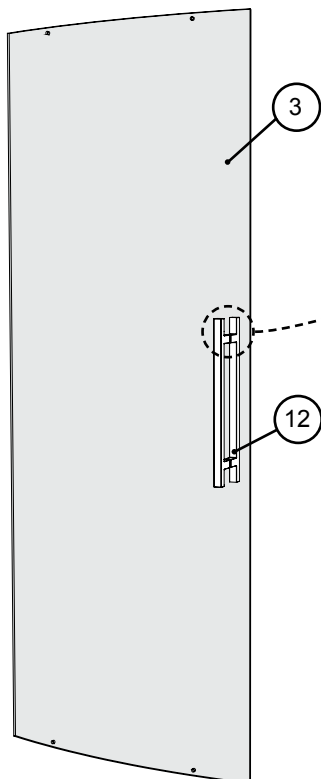

INTERIOR
SHOWER SIDE
INTÉRIEUR
DE LA DOUCHE

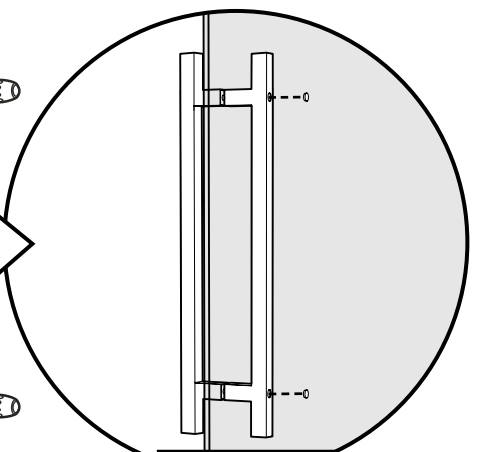

INTERIOR
SHOWER SIDE
INTÉRIEUR
DE LA DOUCHE



ENSURE GASKETS ARE BETWEEN THE GLASS AND
THE HANDLE ON EACH SIDE
ASSURER QUE LES JOINTS SONT ENTRE LE VERRE
ET LA POIGNÉE DE CHAQUE CÔTÉ

INSTALL THE ROLLERS / INSTALLER LES ROULETTES

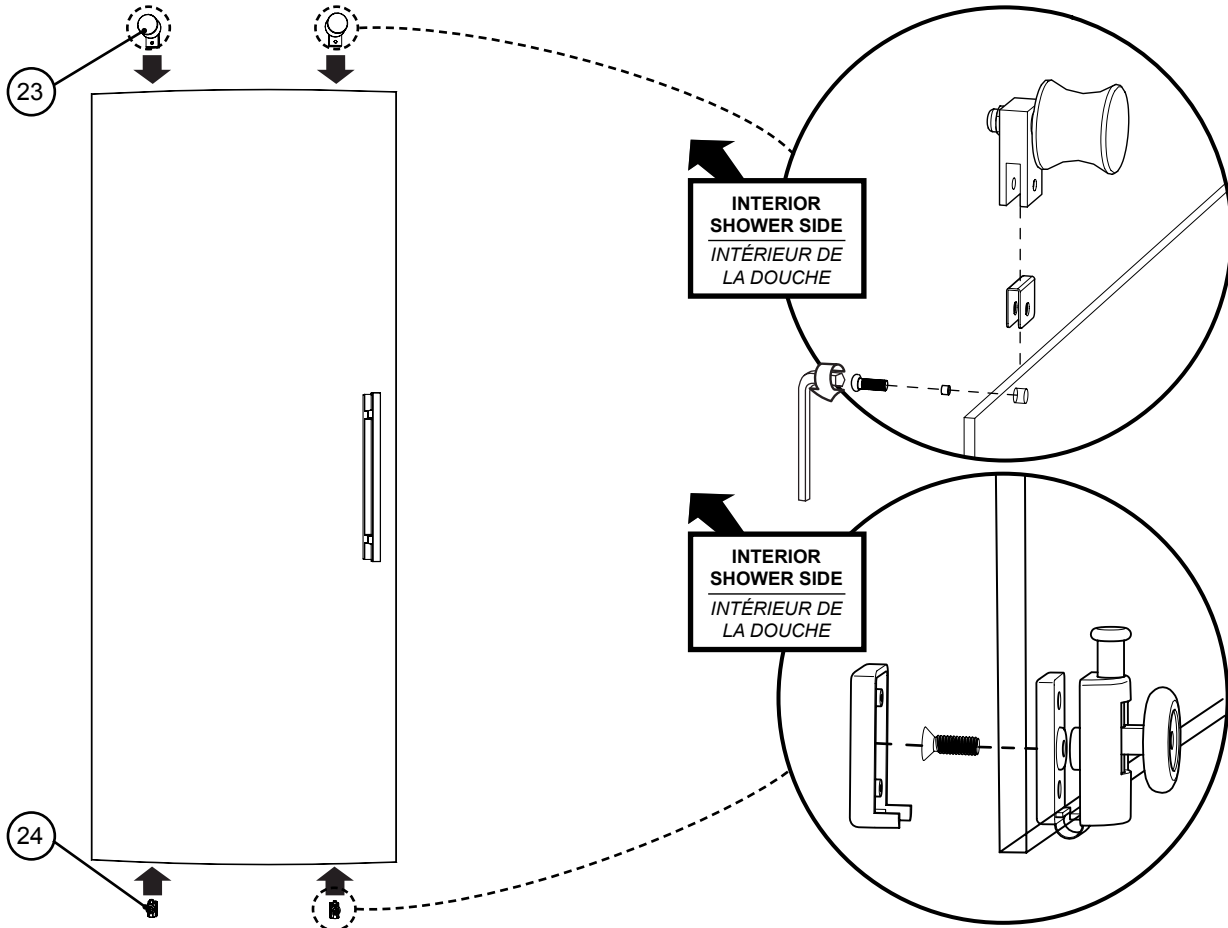

INSTALL THE GASKETS / INSTALLER LES JOINTS

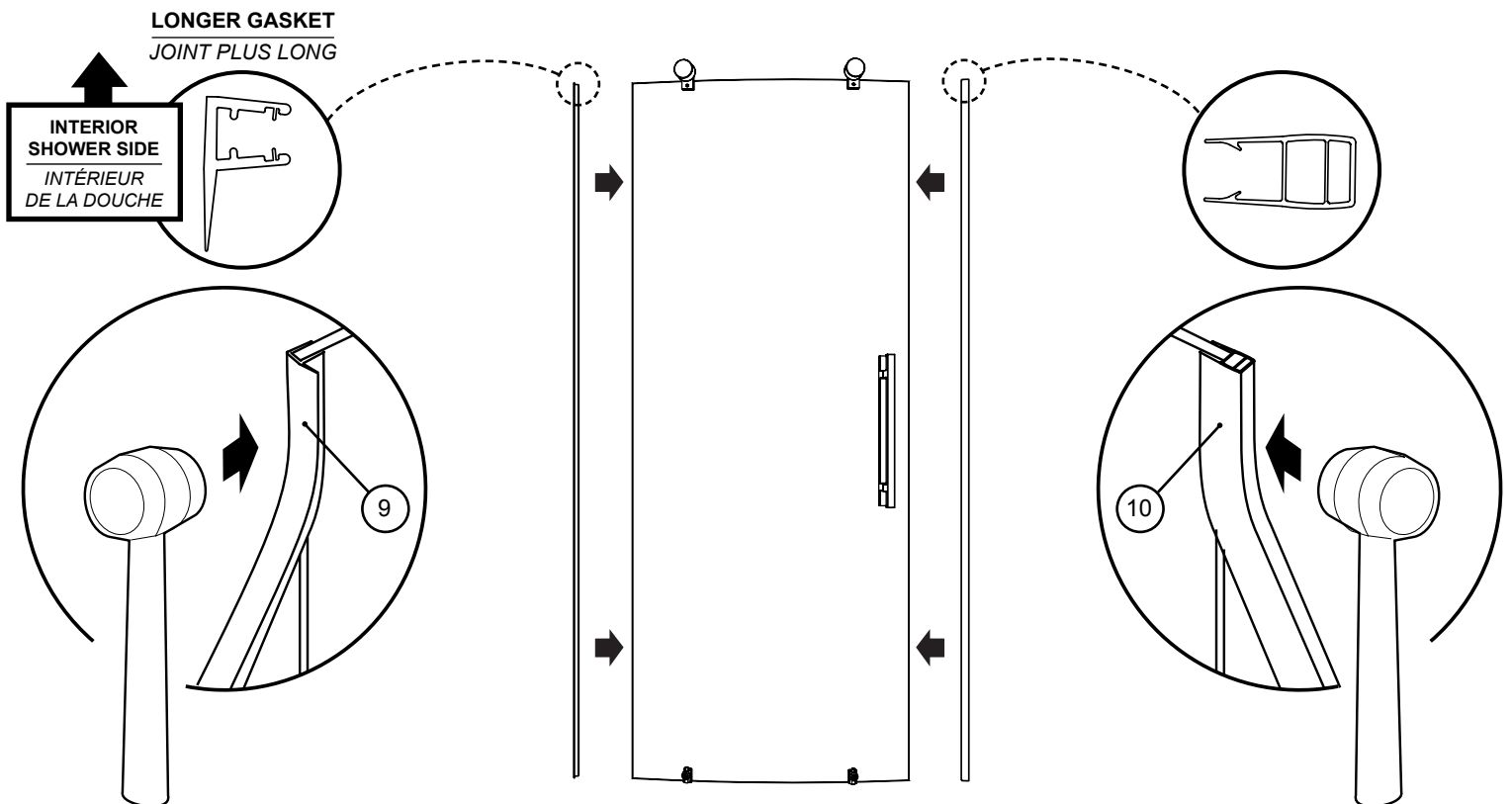

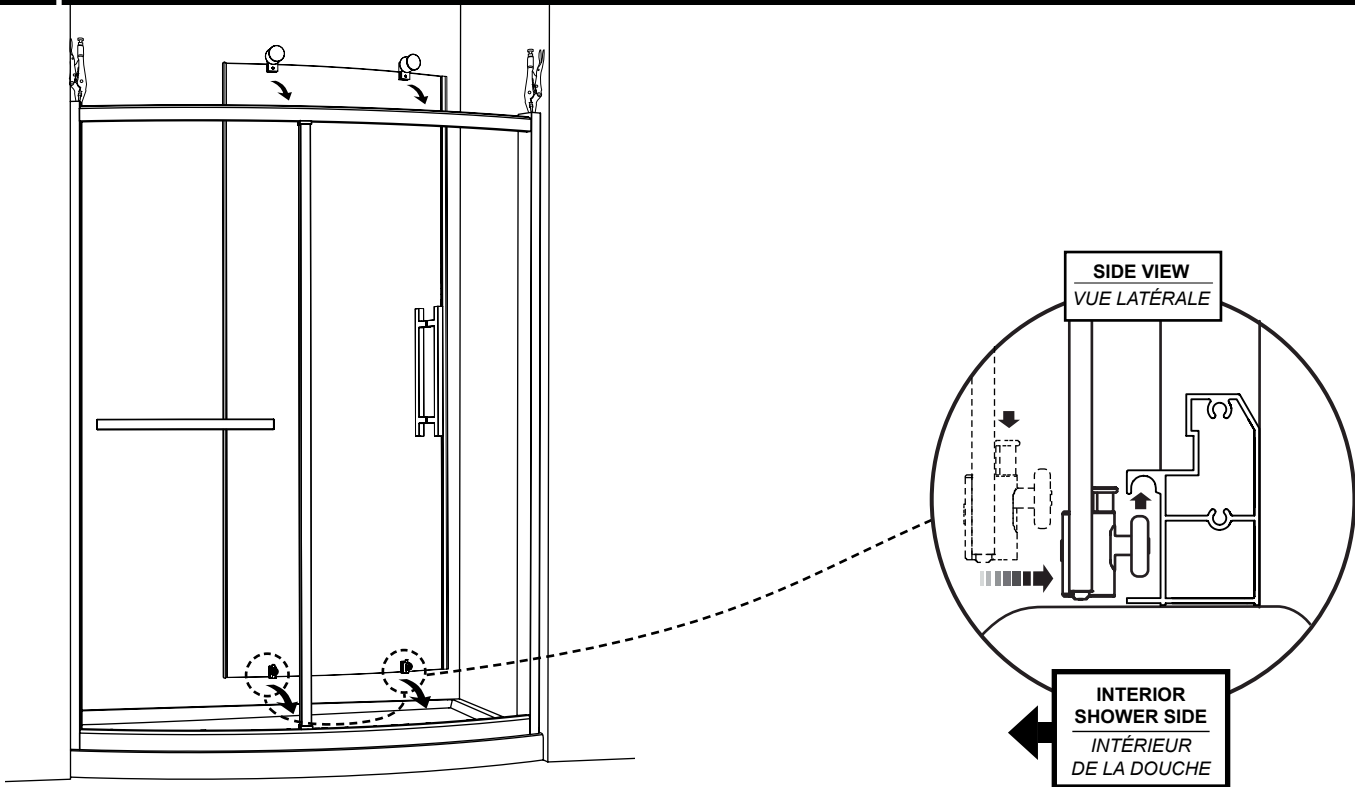

*MODEL SHOWN WITH VERTICAL COLUMN

*MODÈLE CI-DESSUS ILLUSTRÉ AVEC LE MONTANT VERTICAL

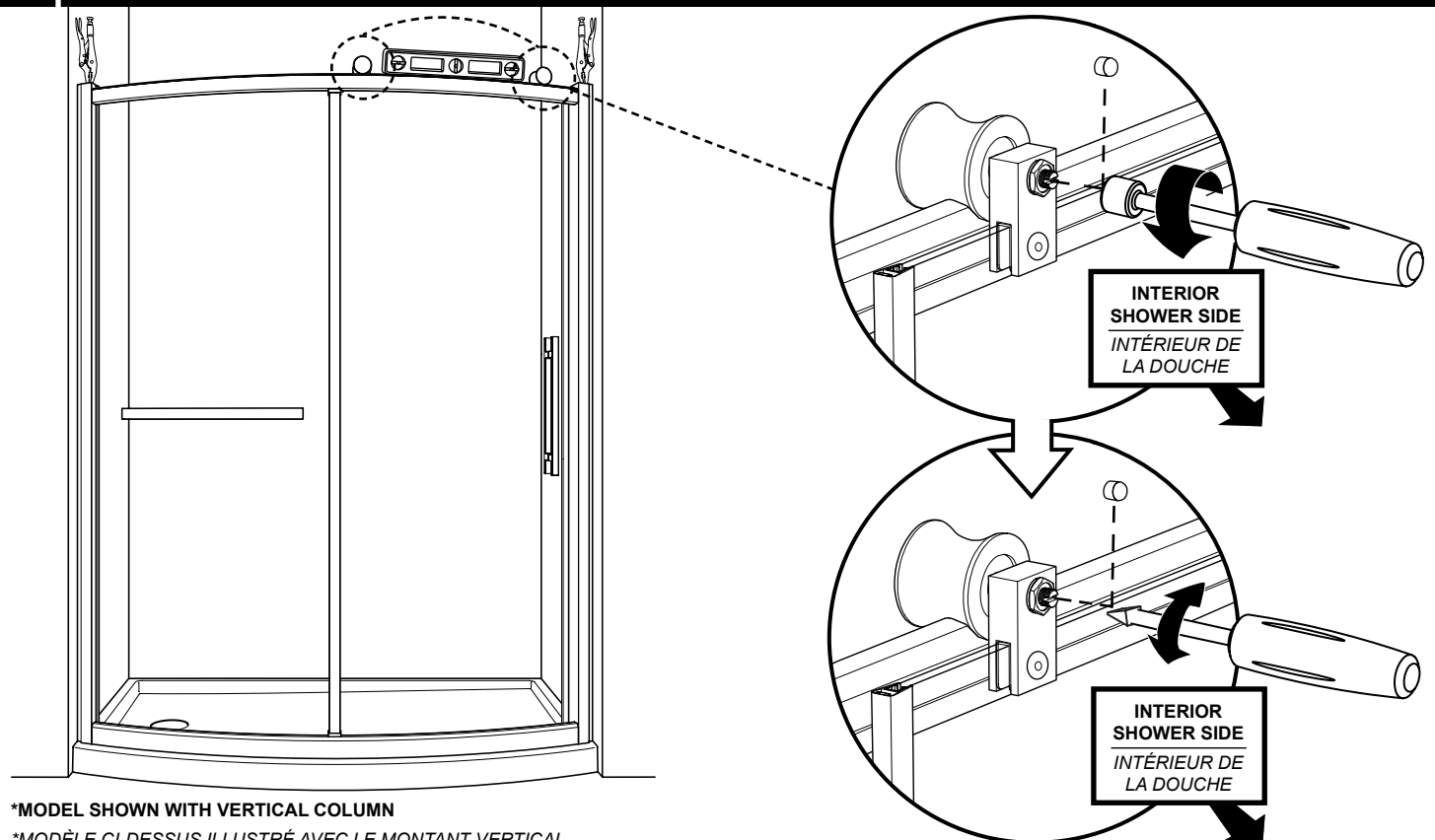

*MODEL SHOWN WITH VERTICAL COLUMN

*MODÈLE CI-DESSUS ILLUSTRÉ AVEC LE MONTANT VERTICAL

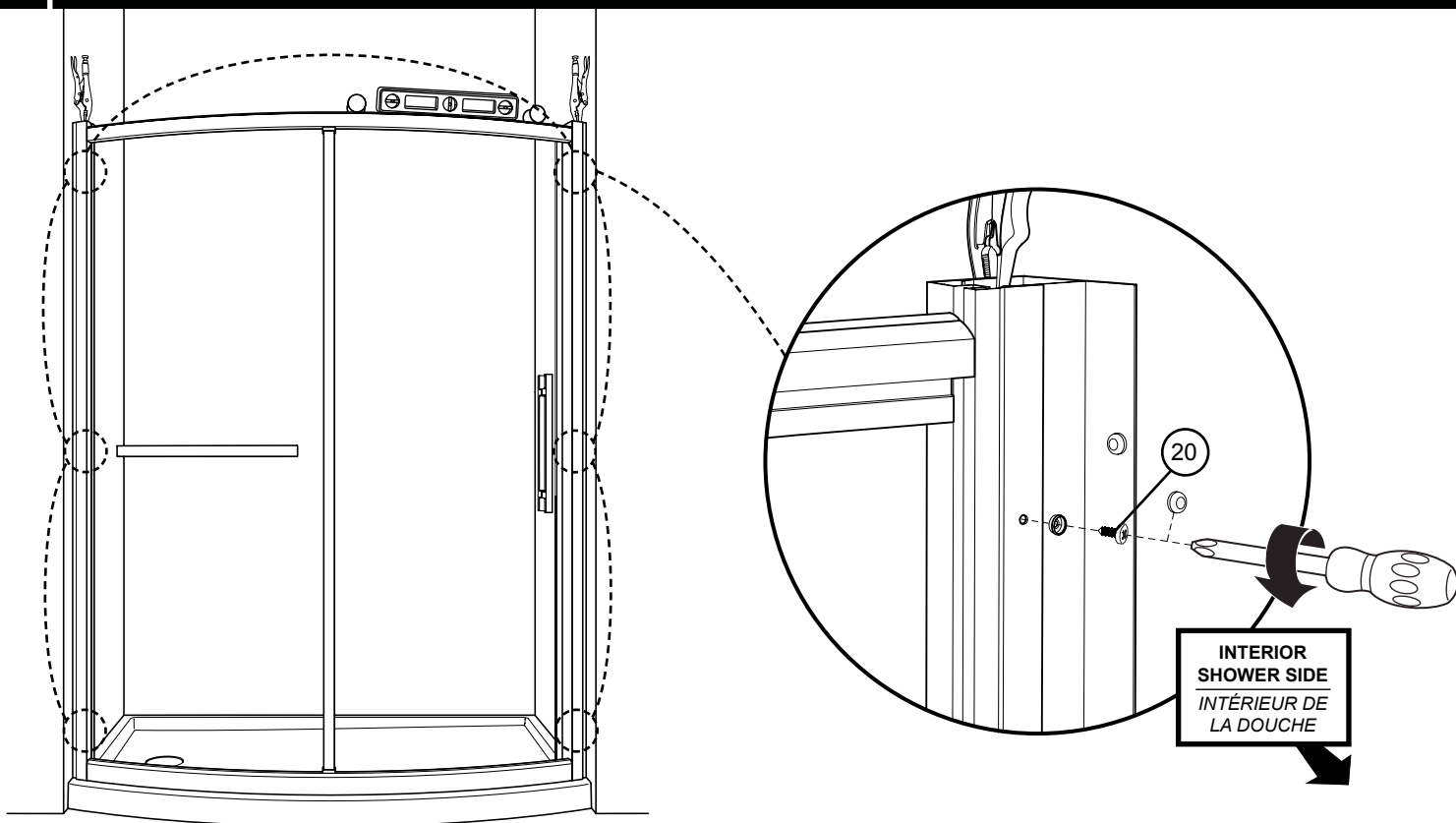

*MODEL SHOWN WITH VERTICAL COLUMN

*MODÈLE CI-DESSUS ILLUSTRÉ AVEC LE MONTANT VERTICAL

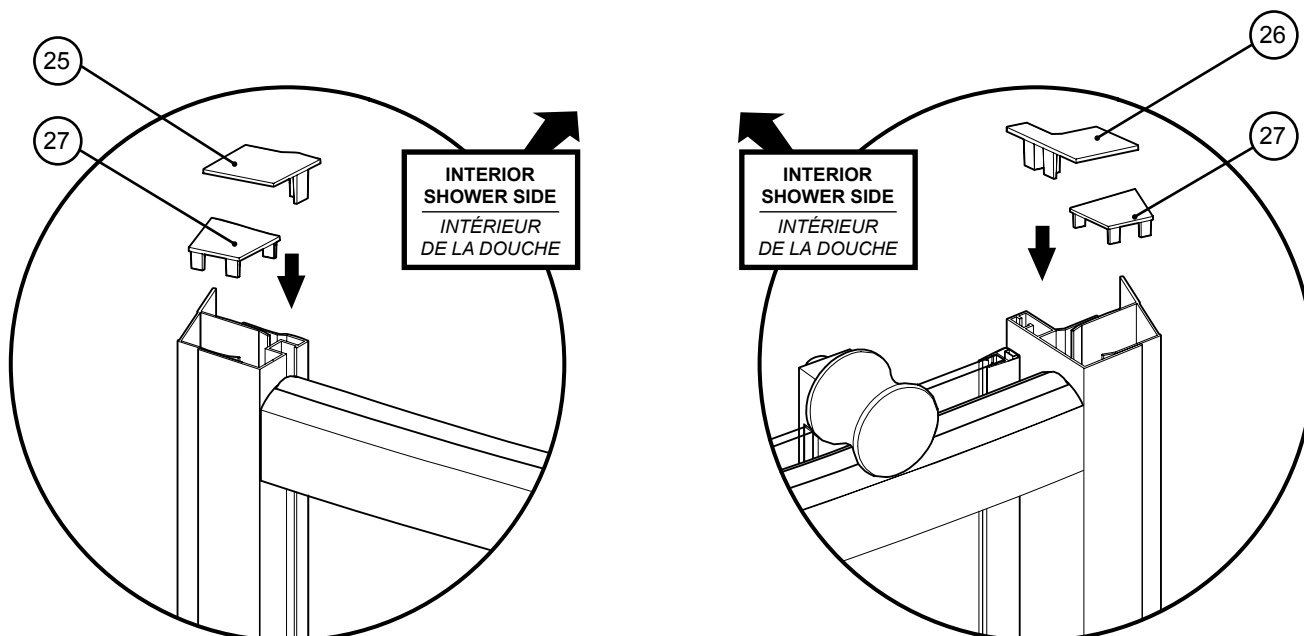

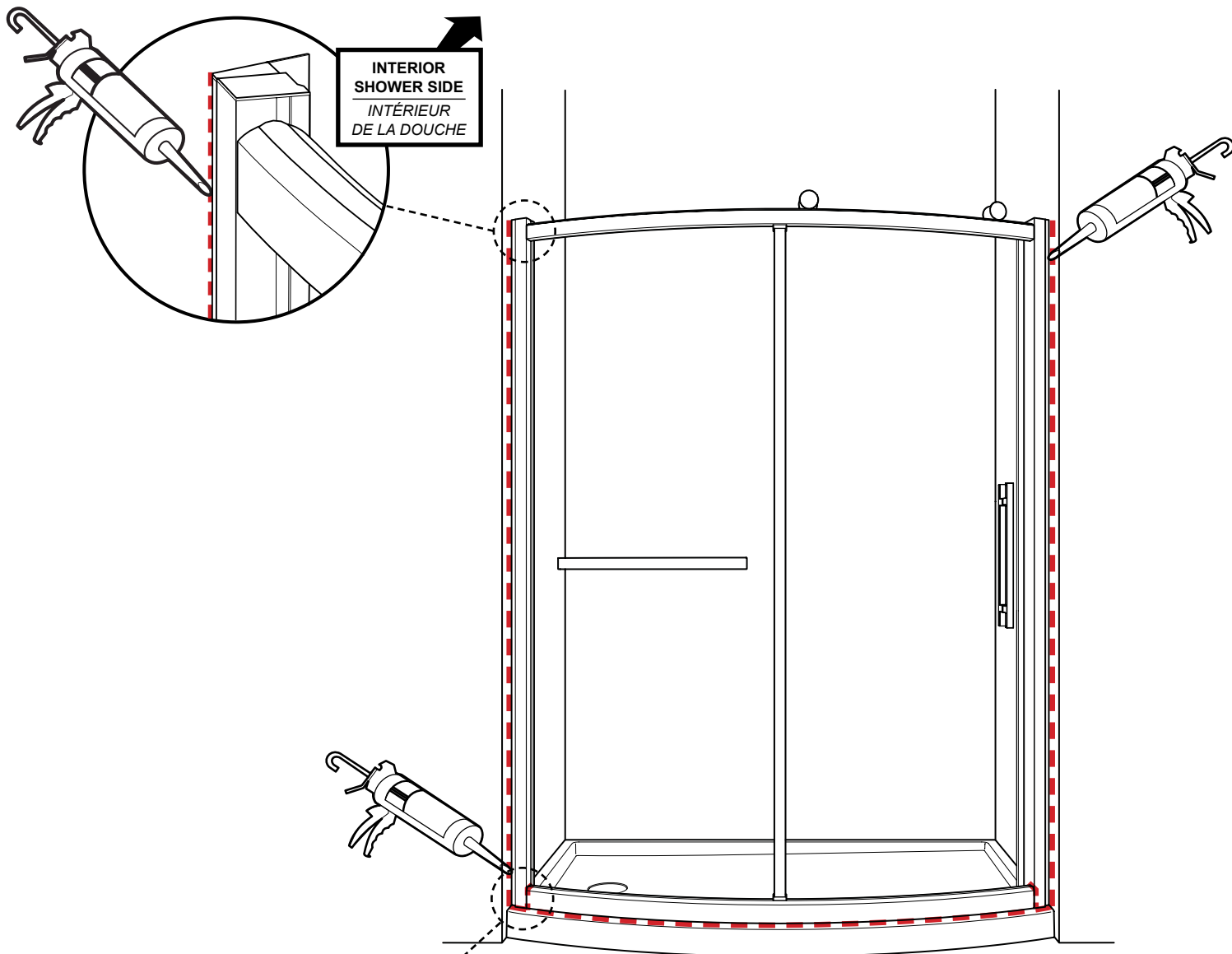

*MODEL SHOWN WITH VERTICAL COLUMN
*MODÈLE CI-DESSUS ILLUSTRÉ AVEC LE MONTANT VERTICAL

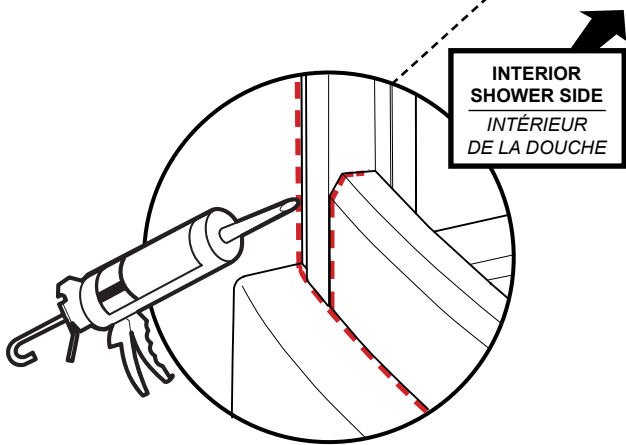

24 HOURS
HEURES